

ASPIRE BY HESTAN

Tower Carts

ECDxx Parts List

Hestan Commercial Corporation
3375 E. La Palma Ave.
Anaheim, CA 92806
(888) 905-7463

RETAIN THIS FOR FUTURE REFERENCE

Last Revised: Aug. 6, 2021

REPLACEMENT PARTS - ASPIRE TOWER CARTS

APPLICABLE MODEL NUMBERS	DESCRIPTION
ECD30	DOUBLE DOOR CART, ASPIRE, 30"
ECD36	DOUBLE DOOR CART, ASPIRE, 36"
ECD42	DOUBLE DOOR CART, ASPIRE, 42"

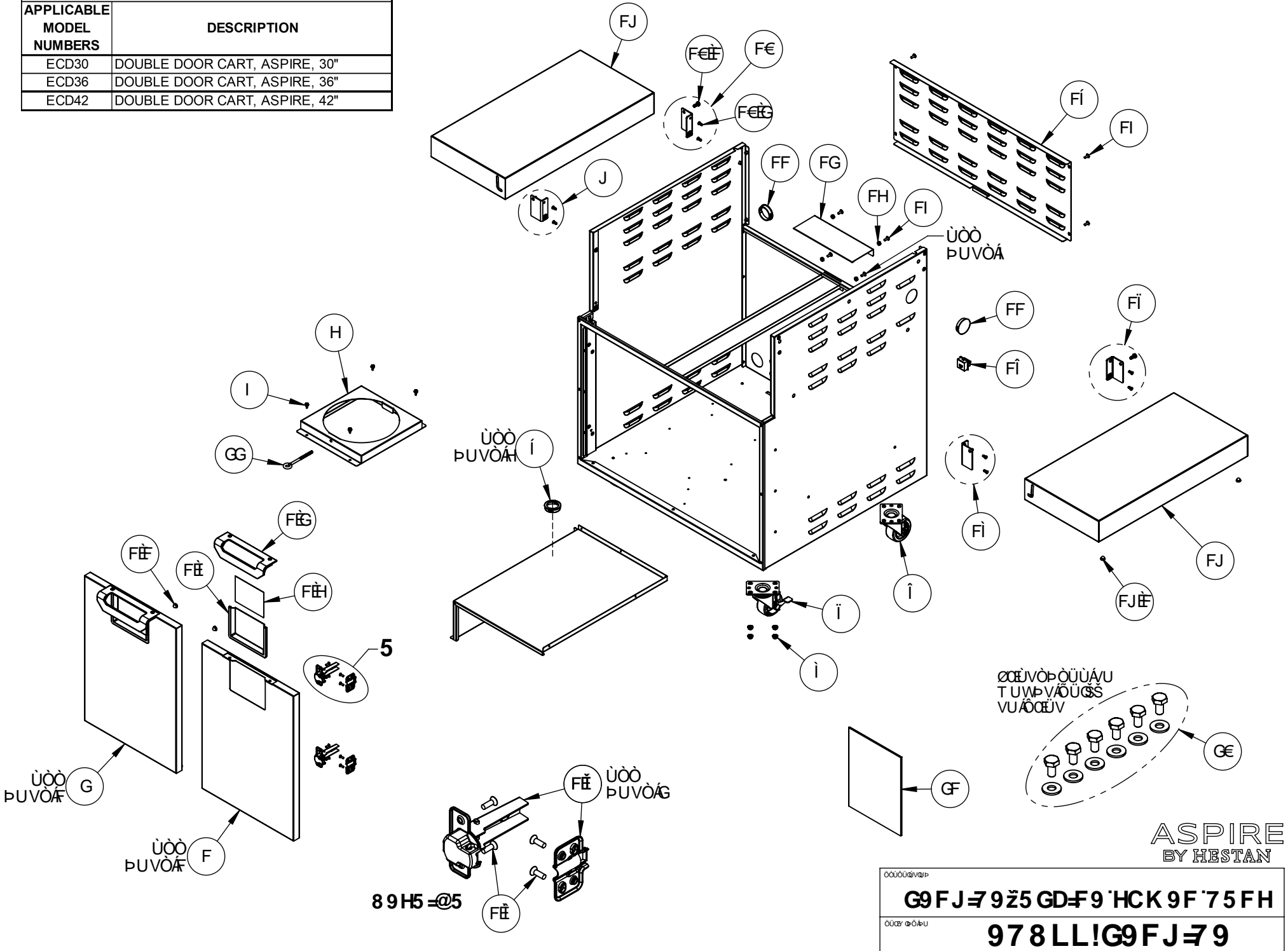

ASPIRE
BY HESTAN

G9 F J 7 9 Ž 5 G D F 9 H C K 9 F 7 5 F H

9 7 8 L L ! G 9 F J 7 9

All warranty and non-warranty repairs should be performed by qualified service personnel. To locate an authorized service agent, contact your Hestan dealer, local representative, or the manufacturer. Before you call, please have the model number and serial number/date code information ready. This is located on a sticker on an inside wall of the cart.

ECD30 ECD36 ECD42

ITEM	PART NO.	DESCRIPTION	QTY		
			ECD30	ECD36	ECD42
1	*017386	SERVICE, DOOR W/ MARQUISE, RH, ASPIRE CART, 30"	1	-	-
	*017388	SERVICE, DOOR W/ MARQUISE, RH, ASPIRE CART, 36"	-	1	-
	*024117	SERVICE, DOOR W/ MARQUISE, RH, ASPIRE CART, 42"	-	-	1
1.1	011691	SERVICE, BUMPER, PLASTIC, .50 DIAM. X 0.11 H, PKG 4	1	1	1
1.2	011760	SERVICE, HANDLE w/ SCREWS, CABINET	1	1	1
1.3	*002554	INSERT, RIGIDIZED, HANDLE	1	1	1
1.4	002559	INSERT, RECESSED, HANDLE	1	1	1
1.5	007869	HINGE, CONCEALED, CLIP-TOP, OVERLAY	2	2	2
1.6	011702	SERVICE, MS, 8-32 X .375, PH, FLT, SS, PKG 8	1	1	1
2	*017389	SERVICE, DOOR W/ MARQUISE, LH, ASPIRE CART, 30"	1	-	-
	*017390	SERVICE, DOOR W/ MARQUISE, LH, ASPIRE CART, 36"	-	1	-
	*024121	SERVICE, DOOR W/ MARQUISE, LH, ASPIRE CART, 42"	-	-	1
3	013415	TANK BASE, ASPIRE CART	1	1	1
4	017382	SERVICE, SMS, TEK, #8 X 1/2", PH, PAN, SS, PKG 6	1	1	1
5	016805	GROMMET, LOCKING, 1-3/4 HOLE KNOCKOUT (SEE NOTE 3)	1	1	1
6	007852	CASTER, SWIVEL, 3", W/O BRAKE	2	2	2
7	007854	CASTER, SWIVEL, 3", W/ BRAKE	2	2	2
8	011853	SERVICE, NUT, LCK, SERRATED FLANGE, 1/4-20, SS, PKG 4	4	4	4
9	009157	ASSY., BRACKET A, SIDE SHELF	1	1	1
10	010569	ASSY., BRACKET B, REAR, SIDE SHELF	1	1	1
10.1	011717	SERVICE, HB, 1/4-20 X .500, SS, PKG 4	1	1	1
10.2	017383	SERVICE, MS, 10-24 X 1/2, PH, FLT, UC, SS, PKG 2	1	1	1

* For colors, add 2 letter color code to end of part number (e.g., 000123-BK)

NOTES:

- EACH ITEM 1 AND 2 COME ASSEMBLED WITH ITEMS 1.1 THRU 1.6.
SPECIFY STAINLESS STEEL OR COLOR WHEN ORDERING. SEE NOTE 2.
- ITEM 1.5 MAY BE FROM 2 MANUFACTURERS - PLEASE TELL CUSTOMER SERVICE IF 'BLUM' OR 'KING' IS ON THE PART.
- THIS ITEM WAS USED ON EARLIER CARTS FOR ROUTING THE POWER CORD THRU THE STORAGE SHELF.
- THESE SCREWS/NUTS (13 & 14) ARE USED TO ATTACH THE GRILL ELECTRICAL BOX TO THE REAR WALL OF THE CART.

ECD30 ECD36 ECD42

ITEM	PART NO.	DESCRIPTION	QTY		
			ECD30	ECD36	ECD42
11	015472	PLUG, ROUND, 1.750 DIA. MOUNT, PLASTIC	2	2	2
12	009191	GUARD, ELEC. BOX, STD CART, GRILL	1	1	1
13	017384	SERVICE, NUT, KEPS, #10-24, SS, PKG 4	1	1	1
14	011713	SERVICE, MS, 10-24 X .500, PH, TRUSS, SS, PKG 8	1	1	1
15	006261-030	ACCESS PANEL, REAR, GRILL, 30	1	-	-
	006261-036	ACCESS PANEL, REAR, GRILL, 36	-	1	-
	006261-042	ACCESS PANEL, REAR, GRILL, 42	-	-	1
16	008055	STRAIN RELIEF, SNAP-IN, 1.14" SQUARE MOUNT	1	1	1
17	010568	ASSY., BRACKET A, REAR, SIDE SHELF	1	1	1
18	009158	ASSY., BRACKET B, SIDE SHELF	1	1	1
19	012663	SIDE SHELF, ASPIRE CART	2	2	2
19.1	011691	SERVICE, BUMPER, PLASTIC, .50 DIAM X 0.11 H, PKG 4	1	1	1
20	010244	KIT, HEX BOLTS & WASHERS, 6 PCS	1	1	1
21	014117	MANUAL, USE & CARE, OUTDOOR ASPIRE GRILL CART	1	1	1
22	010674	EYEBOLT, 1/4-20 X 3.5" SHANK, ZN	1	1	1

COLOR CODE	COLOR
BK	Stealth - Black
RD	Matador - Red
YW	Sol - Yellow
OR	Citra - Orange
BU	Prince - Blue
TQ	Bora Bora - Turquoise
PK	Reef - Pink
DB	Orion - Dark Blue

* For colors, add 2 letter color code to end of part number (e.g., 000123-BK)