

# CU800 & CU500 UTV

## DEALER SETUP INSTRUCTIONS



# PARTS

Utv chassis



Hardware Pack



Steering Wheel



ROPS Cage Assembly

Seat back and bench seat



Front Roll Cage Boots



Rear Roll Cage Boots



Windshield and Clamps

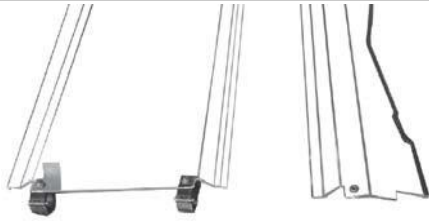

Front Bumper and Bars  
*Accessory, not on all models*



Mirrors



Head Rests



Battery, Electrolyte & Bracket



# HARDWARE KIT REFERENCE

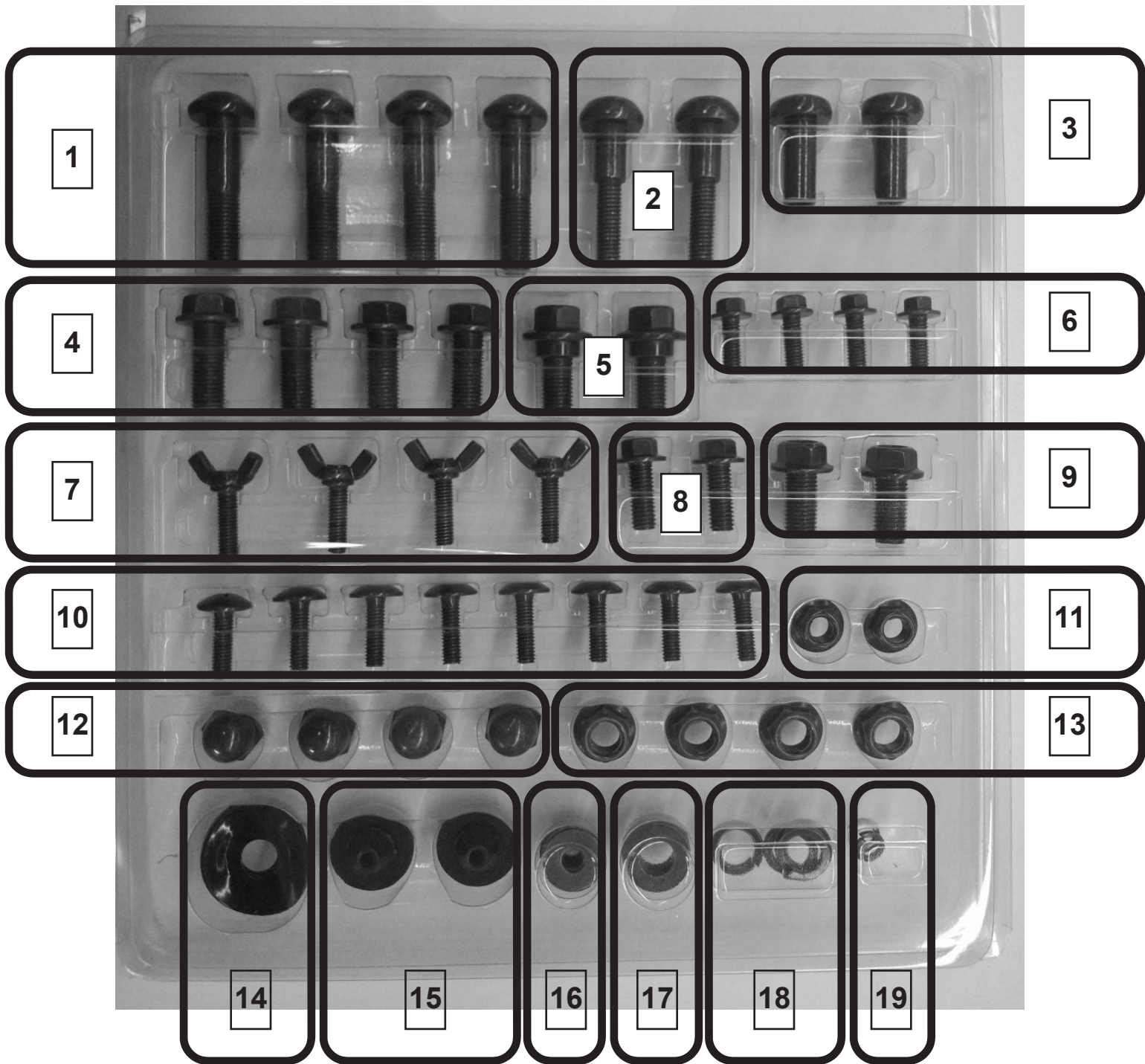

Ref. 1	M10X45 Allen Head Bolt	QTY. 4	Ref. 10	M6X20 Screw	QTY. 8
Ref. 2	M8 Shoulder Bolt	QTY. 2	Ref. 11	M8 Lock Nut	QTY. 2
Ref. 3	M8 Shoulder Nut	QTY. 2	Ref. 12	M10 Cap Nut	QTY. 4
Ref. 4	M10X25 Bolt	QTY. 4	Ref. 13	M10 Lock Nut	QTY. 4
Ref. 5	M10 Shoulder Bolt	QTY. 2	Ref. 14	M10 Concave Washer	QTY. 4
Ref. 6	M6X16 Bolts	QTY. 4	Ref. 15	Rubber Battery Pads	QTY. 2
Ref. 7	M6X20 Wing Bolt	QTY. 4	Ref. 16	M6 Flat Washer	QTY. 6
Ref. 8	M8X20 Bolt	QTY. 2	Ref. 17	M10 Flat Washer	QTY. 4
Ref. 9	M10X20 Bolt(Spares)	QTY. 2	Ref. 18	M10 Lock Washer	QTY. 4
			Ref. 19	M6 Lock Washer	QTY. 2

# STEERING WHEEL INSTALLATION



Steering wheel

## Tools needed:

**4mm - Allen Head Wrench**



Center Horn

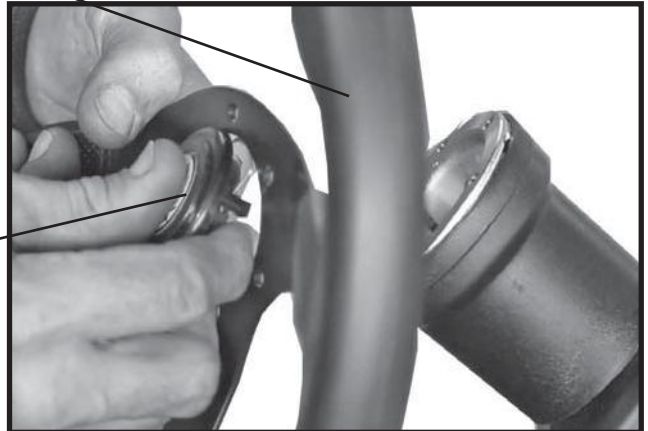

Horn wire Connector

Note: Before steering wheel install, make sure the front tires are straight and in line with the rear tires. Uninstall the 6 - M5X20 allen bolts and clamp ring from the steering column.

1. Install horn in steering wheel and attach horn wire (located in the steering column) to back of horn.



2. Install steering wheel with large open area on top portion of steering wheel, facing up.

3. Rotate steering collar (piece directly behind steering wheel, on the column) and install allen bolts at 2 o'clock and 8 o'clock position through the clamp ring first.

Note: If these 2 bolts are not installed first, the steering collar will rotate freely.

4. Install remaining bolts through the clamp ring and tighten all securely.



Clamp ring



M5X20  
Allen head bolts



# ROPS CAGE INSTALL

## Tools needed:

**8mm - Allen Head Wrench**

**14mm Socket/Wrench**

ROPS cage assembly



Front roll cage boot

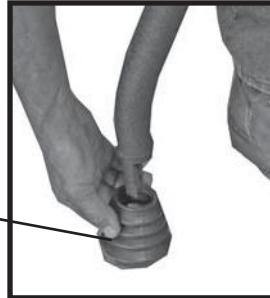

Rear roll cage boot

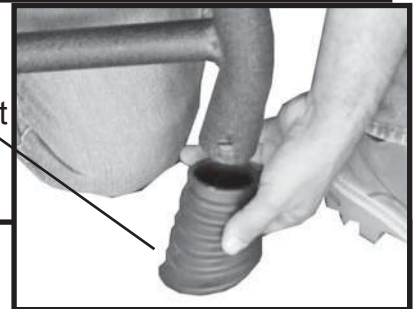

1. While on the ground, place front and rear roll cage boots onto the appropriate bars.

2. With assistance, lift the cage assembly onto the mounting locations.

Note: The rear points install through the bars vertically and the front points are side by side.

3. Install ROPS cage with hardware provided. Note: Do not tighten any hardware until all hardware is in place.

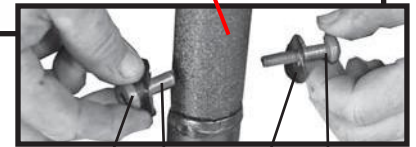

M10X45  
Allen head bolt  
(Hardware Fig. #1)

M10 Lock Washer  
(Hardware Fig. #18)

M10 Cap Nut  
(Hardware Fig. #12)

M10 Flat Washer  
(Hardware Fig. #17)

M8 Shoulder Nut  
(Hardware Fig. #3)

M8 Shoulder Bolt  
(Hardware Fig. #2)

2 - M10 Concave Washer  
(Hardware Fig. #14)

# HEADRESTS, SEAT BELTS AND SEAT BACK ATTACHMENT

4 - M6X15 Screws (per side)  
(Hardware Fig. #10)

M10 Shoulder Bolt (per side)  
(Hardware Fig. #5)

M10 Lock Nut (per side)  
(Hardware Fig. #13)

## Tools needed:

**10mm Socket/Wrench**  
**12mm Socket/ Wrench**  
**14mm Socket/Wrench**  
**Phillips screw driver**

1. Attach head rests to roll cage assembly using M6X15 screws.

2. Attach back rest to roll cage using M6X16 bolts, M8 spring washers and M8 flat washers.

3. Attach rear plastic backing to rear of seat back using 2 - M6X20 Screws (outer) and 2 - M6X12 Screws (inner.)

Note: M6X20 and M6X12 Screws are already installed on seat back. They must be removed and reinstalled during this process.

4. Attach seat belt assembly to roll cage using M10 shoulder bolt and M10 lock nut.

Note: Take care in alignment of the seat belt. Make sure it isn't twisted prior to install. The top curved mount should be curving toward the front of the UTV after install.

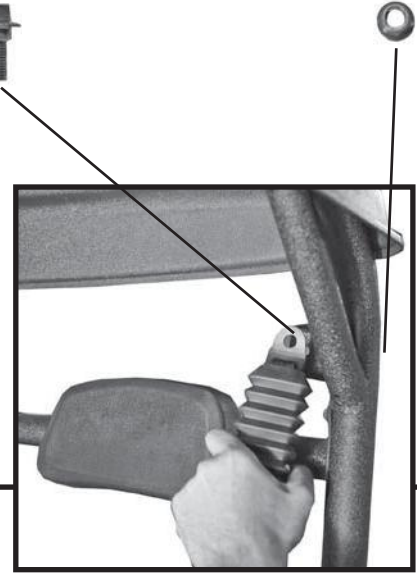
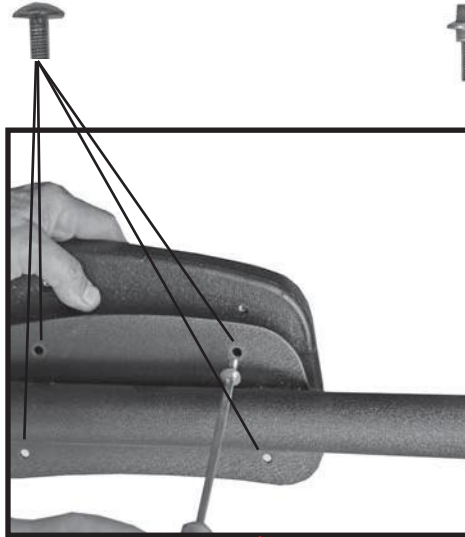

2 - M6X16

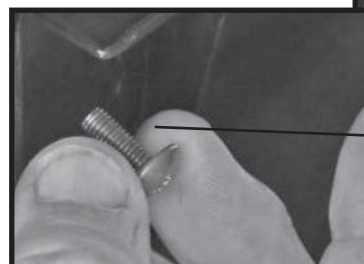

2 - M6X20  
Seat back screws  
(outer)

2 - M6X12  
Seat back screws  
(inner)

# FRONT BUMPER INSTALL

## Tools needed:

- 8mm Socket/Wrench**
- 10mm Socket/Wrench**
- 12mm Socket/Wrench**

1. Install bumper bars on the inside of both mounting points using M8X20 Bolts and M8 Lock Nuts.

Note: The flatter side of the bar should be facing inside. The circular mounting hole on the bar is the bumper side mount. Do not fully tighten bolts until bumper is mounted.

2. Lift front bumper assembly in place and attach the vehicle side bumper bar mount with M10X25 Bolts and M10 Lock Nuts.

Note: The vehicle side bumper bar should be mounted on the outside. Do not fully tighten until bottom mounts are secured.

3. Attach bottom of bumper assembly with M10X25 Bolts.

4. Tighten bumper bar bolts and nuts.

5. Attach wires to winch. Red wire to top (+) and black wire to bottom (-).

6. Plug in headlight plugs and zip tie wires to bumper bars.

M8 Lock Nut (per side) (Hardware Fig. #11)      M8X20 Bolt (per side) (Hardware Fig. #8)



M10X25 Bolt (per side) (Hardware Fig. #4)

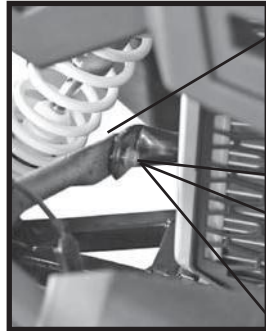

M10 Lock Nut (per side) (Hardware Fig. #13)

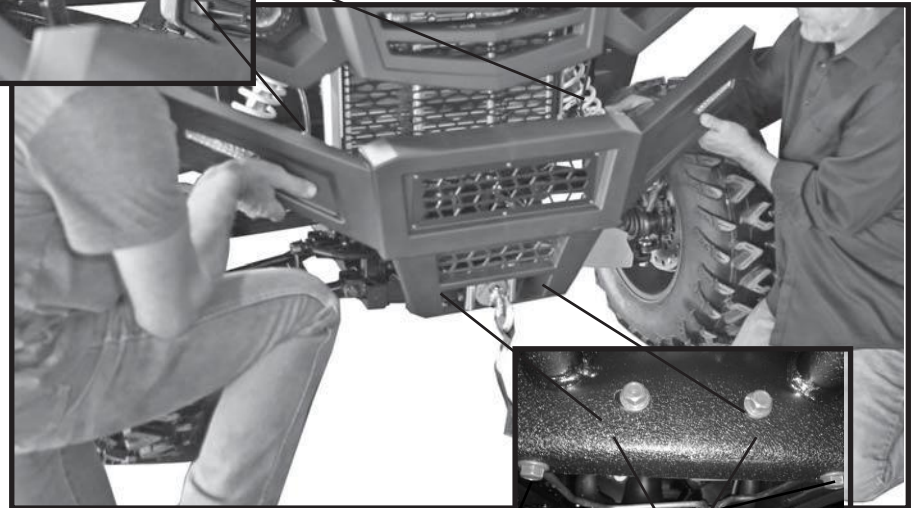

2-M10x20 Bolt (Hardware Fig.#9)

2 - M10X25 Bolt (Hardware Fig. #4)

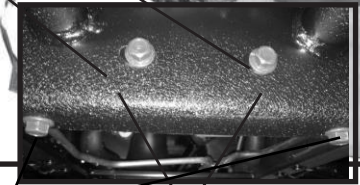

Headlight plugs

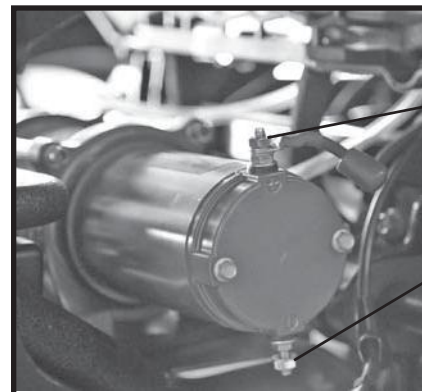

Red wire to +

Black wire to -

# WINDSHIELD AND MIRROR INSTALL

## Tools needed:

**4mm Allen head wrench**

**Phillips screw driver**

Rubber strap for mounting location protection

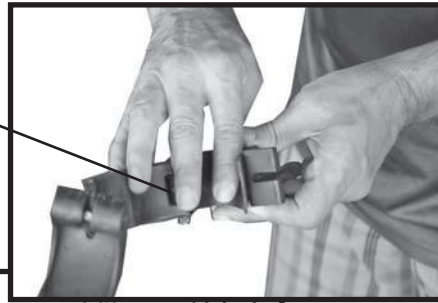

1. Install rubber straps in buckle assemblies for windshield.

2. Install buckle assemblies using M6 Screws

3. Place bottom portion of windshield on UTV

4. Install mirrors on both sides of UTV in slotted portion of windshield

5. Install top portion of windshield on UTV.

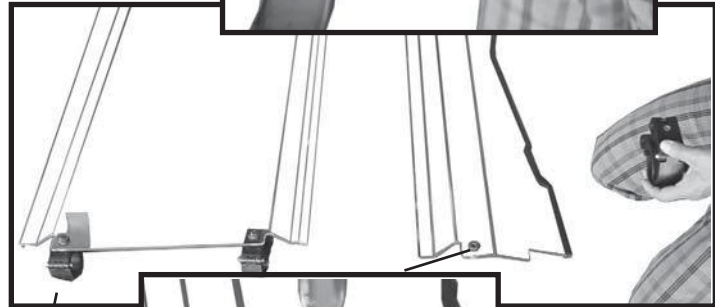

Window buckles

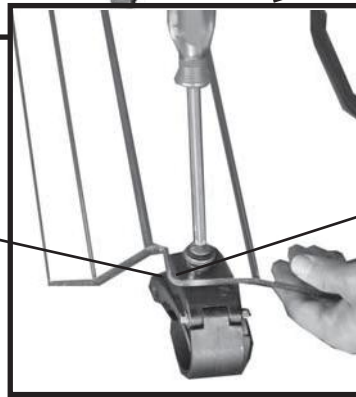

M6 Screws

Bottom windshield



Mirror assembly

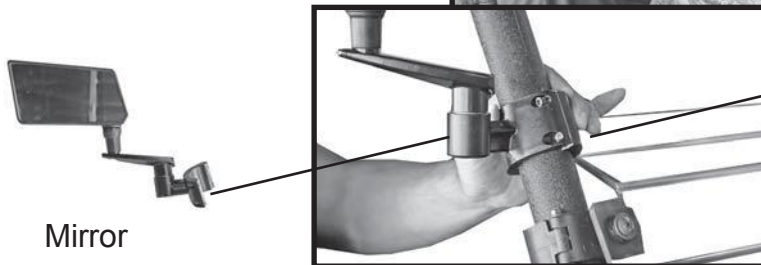

Mirror

Mirror bracket

Top windshield





# PARTS SCHEMATIC REFERENCE

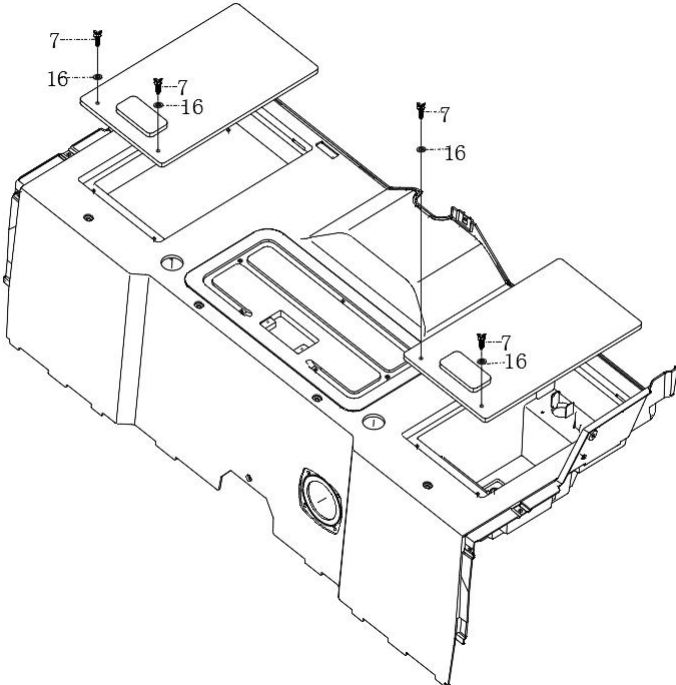
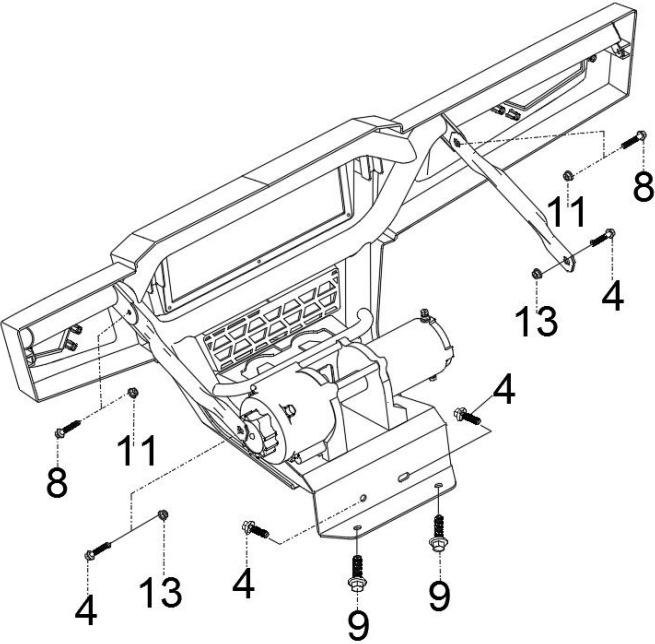
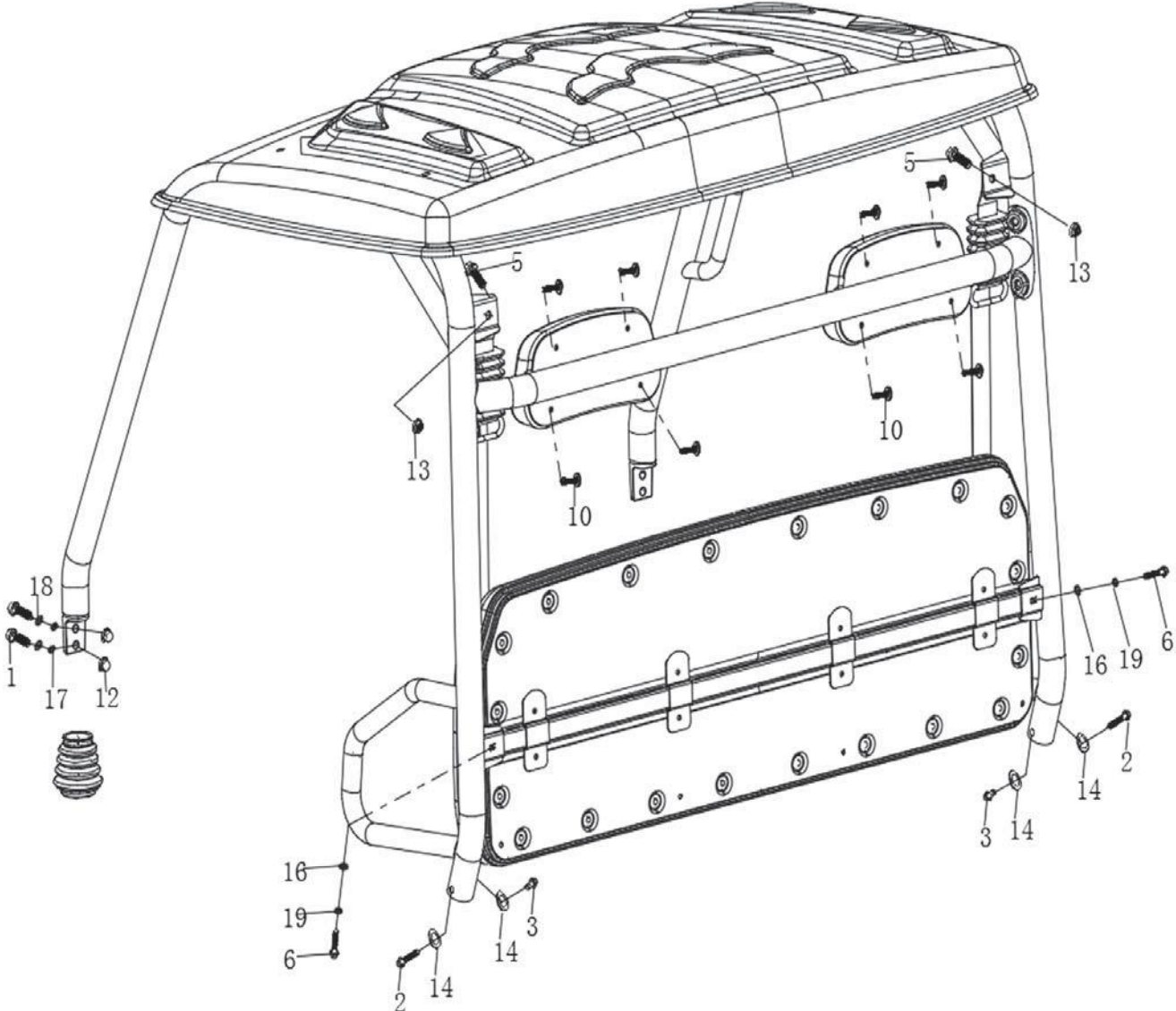

## LEAD-ACID BATTERY INSTALL

1、 take out the lead-acid battery from the vehicle.



Battery place position,under the



2、 The battery package as below



3、 Open the battery package



4、 The details parts within the battery box.



Lead-acid battery,Plugs



Front of instruction



Backside of instruction



5、 Tear off the seal on the battery.



Tear off the sealing



6、 After tearing off the seal, the hole for electrolyte is in view.



7、 Use a funnel to add the electrolyte in each cell and keep electrolyte at a reasonable position

Use a funnel to add and take care to protect the skin. To prevent burns



Electrolyte

Remarks: this 2 sample is shipped without electrolyte, since this is dangerous item, we are worry the inspection will delay this shipment. Please just purchase it from your local market.



8、 The capacity of electrolyte is between mix-max. Fasten the plug of the battery tightly after adding.

MAX

MIX



Fasten the plugs one by one



9、 Pay attention to the positive and negative poles when connecting.

positive+

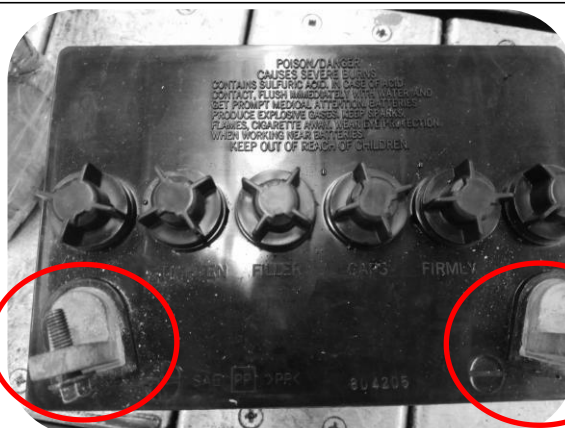

Negative-