

GREENWORKS

COMMERCIAL

QUICK START GUIDE GUIDE DE DÉMARRAGE RAPIDE GUÍA PARA COMIENZO RÁPIDO



Missing parts, accessories or need a service center?

Do Not Return to Store
Call: 1-855-470-4267

www.greenworkstools.com/82v-Commercial/



Vous avez besoin de pièces, d'accessoires ou
d'un endroit où faire réparer l'appareil?

Ne pas retourner au magasin
Appeler: 1-855-470-4267

www.greenworkstools.com/82v-Commercial/



¿Faltan piezas o accesorios o necesita ponerse
en contacto con un centro de reparación?

No la regrese al almacén.
Llame al: 1-855-470-4267

www.greenworkstools.com/82v-Commercial/

HOLSTER AND BATTERY INSTALLATION

1. Attach the holster to the waist belt.
2. Close the hook and eye fastener.
3. Insert battery into the holster.
4. Attach the strap to the velcro in the holster.

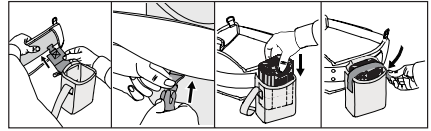

CONNECT BATTERY WITH PLUG

1. Insert plug into the side of the battery holster.
2. Push the plug into the connecting port until it stops. Turn the plug clockwise until the latch engages.
3. Repeat the steps above to connect plug to the battery adapter.

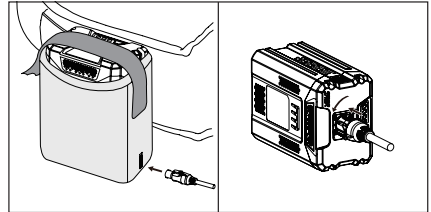

BATTERY HARNESS

1. Fasten and adjust the waist belt (1) so that it rests comfortably on your hips – thread the end of the belt through the loop (2) – do not let the strap hang down.
2. Adjust the harness straps (3) to the correct length.
3. Adjust chest strap (4) to correct length and fasten it.

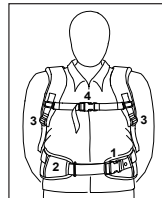

HARNESS ADJUSTMENT

1. Pull the ends of the straps downward to tighten the harness.
2. Lift the tabs of the adjusters to loosen the straps.
3. Close and lock the quick-release fastener by pushing it together.
4. Squeeze the hooks to open the quick-release fastener.

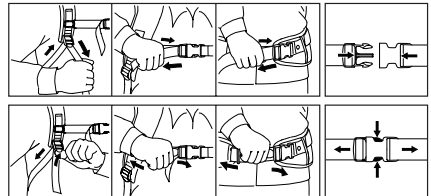

CONNECT BATTERY ADAPTER TO TOOL

Insert the battery adapter into the tool. The adapter slides into the battery compartment. Press down until it snaps into position. The battery and the tool are now connected together, and ready for use.

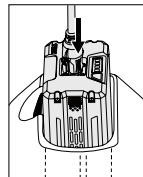

DISCONNECT BATTERY ADAPTER FROM TOOL

1. Turn power off to tool.
2. Depress latch (1) to unlock the battery adapter.
3. Remove battery adapter (2) from the tool.

