

EN

ZERO-TURN MOWER

ASSEMBLY GUIDE

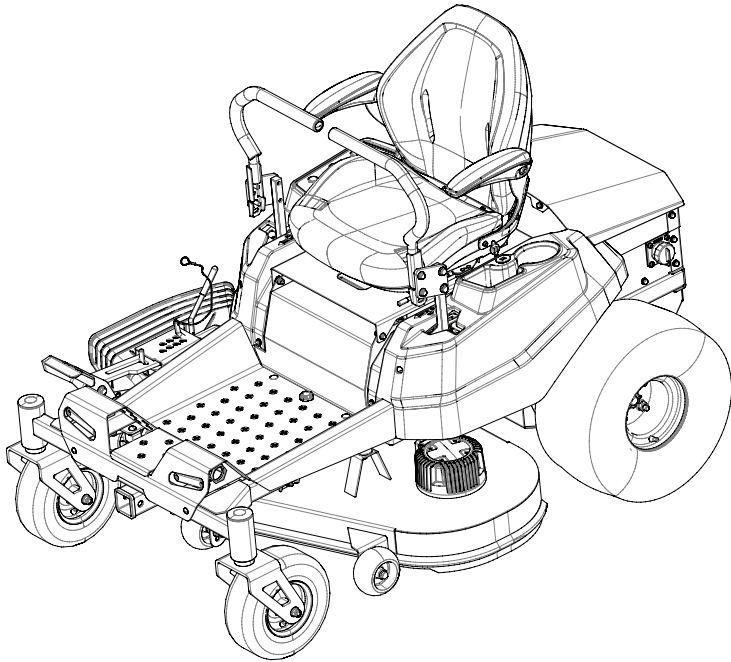

SYMBOLS

Rules for Safe Assembly.....	2
Symbols.....	3
Tools Needed.....	3
Unpacking.....	4
Loose Parts List.....	5
Assembly.....	6-7
Final Preparation.....	8

RULES FOR SAFE ASSEMBLY

⚠ WARNING

Strictly adhere to all torque wrench tightening specifications. Failure to do so could cause serious personal injury.

All information, illustrations, photographs, and specifications contained in this manual are based on the latest product information available at the time of publication. Due to improvements or other changes, there may be some discrepancies in this manual. We reserve the right to make



product changes at any time, without notice and without incurring any obligation to make the same or similar changes to any products previously built or sold.

- Any person attempting to assemble this product must have proper training and experience. Read this manual carefully and follow all assembly procedures as described.
- All assembly must be completed with the unit on a level surface.

SAVE THIS GUIDE FOR FUTURE REFERENCE

SYMBOLS

The following signal words and meanings are intended to explain the levels of risk associated with this product.

SYMBOL	SIGNAL	MEANING
	DANGER	Indicates an imminently hazardous situation, which, if not avoided, will result in death or serious injury.
	WARNING	Indicates a potentially hazardous situation, which, if not avoided, could result in death or serious injury.
	CAUTION	Indicates a potentially hazardous situation, which, if not avoided, may result in minor or moderate injury.
	CAUTION	(Without Safety Alert Symbol) Indicates a situation that may result in property damage.

WARNING

To avoid serious personal injury, do not attempt to use this product until you have read this Owner's Manual thoroughly and understand it completely. If you do not understand the warnings and instructions in this Owner's Manual, do not use this product. Call the Toll-free Helpline (1-888-909-6757) or www.greenworkstools.com for assistance.

TOOLS NEEDED

The following tools (not included or drawn to scale) are needed for assembly:

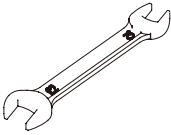

WRENCH (1)
10mm*13mm

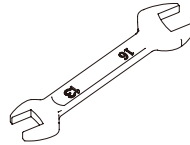

WRENCH (1)
13mm*16mm



SCISSOR (1)

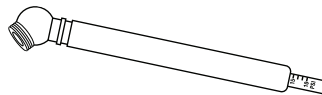

TIRE PRESSURE GAUGE (1)

UNPACKING

⚠ WARNING

If any parts on the Loose Parts List are already assembled to your product when you unpack it, verify the part is assembled correctly, is properly tightened, and is torqued correctly (where applicable) before proceeding to the next assembly step. Use of a product that may have been improperly assembled could result in serious personal injury.

- Inspect the product carefully to make sure no breakage or damage occurred during shipping.

NOTE: Mower should be assembled while positioned on the frame bottom. Once assembly is complete, raise the cutting deck to its highest position, then position a ramp next to the frame bottom and slowly and carefully drive mower off frame.

⚠ WARNING

Use care when driving the mower off of the frame and press the brake pedal as needed to control the speed. The mower will freely roll if it is moved on an inclined surface without pressing the brake pedal or setting the parking brake. Failure to follow these instructions can result in loss of control and result in death, serious personal injury, or property damage.

⚠ WARNING

If no ramp is available, slowly and carefully drive the mower off the frame in reverse while looking down and behind. Driving the mower off the frame in the forward direction without a ramp can cause damage to the mower's cutting deck.

- ① Remove the five bolts from the top side brace and end beam on both sides of the crate,

NOTE: Wrench size: 10mm*13mm and 16mm.

- ② Remove the two beams.
- ③ Remove the side plate assembly.
- ④ Drive the machine off the metal crate.

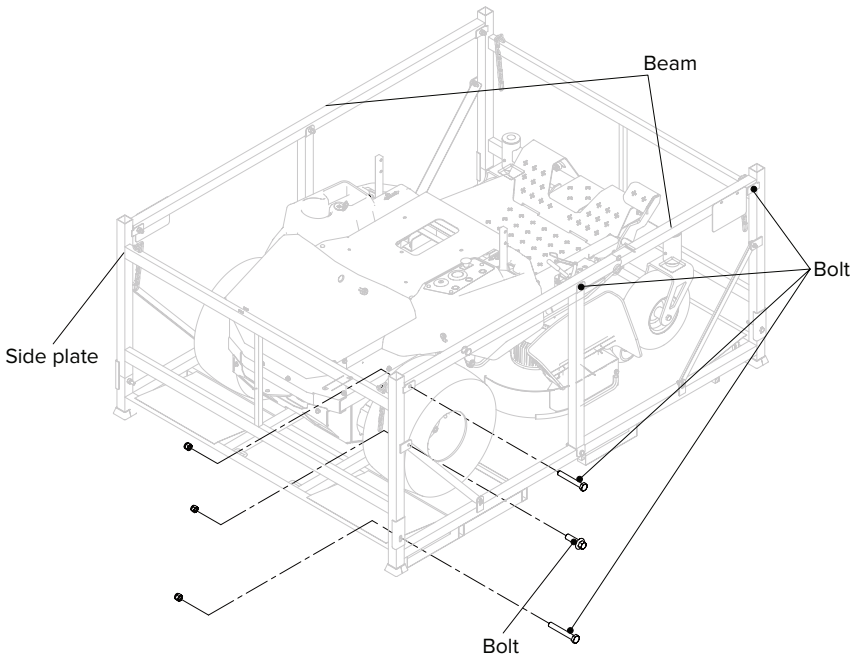

LOOSE PARTS LIST

No.	Description	Qty.
1	Seat assembly with seat switch	1
2	Charger	1
3	Steer control lever	2
4	Key	2
5	Manual (Not Shown)	6

⚠ WARNING
 If any parts are damaged or missing do not assemble this product until the parts are replaced with new original manufacturer's parts or their equivalent. Assembly of this product with damaged, missing, or incorrect parts could result in serious personal injury.

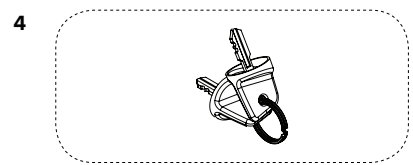
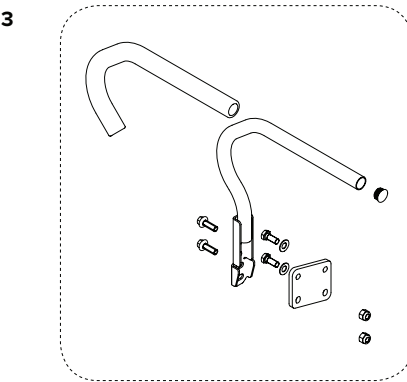
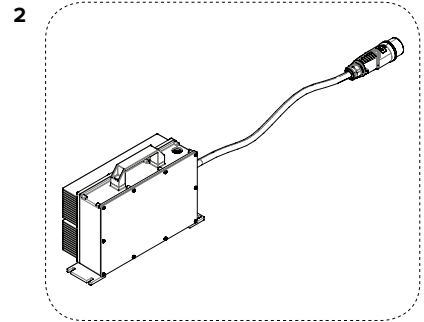
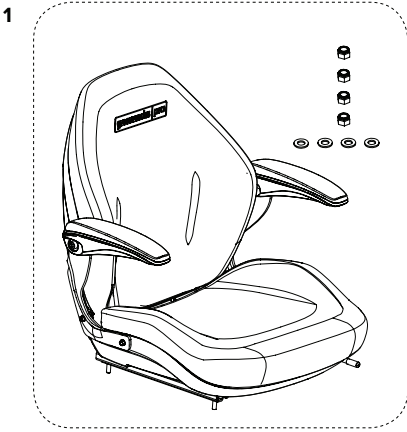

ASSEMBLY

⚠ WARNING

Strictly adhere to all torque wrench tightening specifications. Failure to do so could cause serious personal injury.

⚠ WARNING

Do not attempt to modify this product or create accessories not recommended for use with this product. Any such alteration or modification is misuse and could result in a hazardous condition leading to possible serious personal injury.

⚠ WARNING

To prevent accidental starting that could cause serious personal injury, always remove the start key from the tool when you are assembling parts.

CHARGE THE MOWER

1. Insert charger plug into charging port on mower, making sure it is properly connected.
2. Connect charger to power supply using normal household current of 120V/60HZ AC with at least a 10A circuit.
3. Do not charge in an area of extreme heat or cold.
4. Remove the charger from the mower once it is fully charged and ready for use.

i NOTE

Always connect the mower to the charger when the unit is not in use. If it is not possible to leave the mower charger connected, make sure to charge the batteries fully at least once a month.

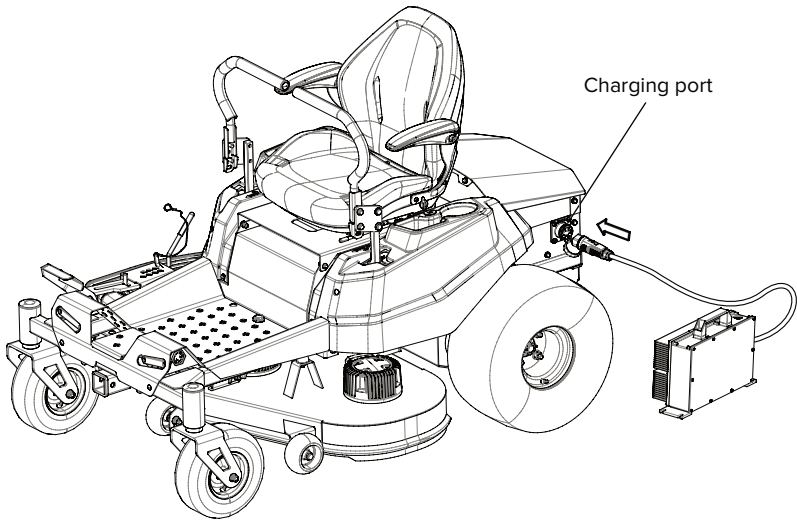

ASSEMBLY

INSTALL THE SEAT

1. Place the seat assembly over the seat plate, insert the seat studs through the holes.
2. Install the washer and nut on all four studs and tighten securely.
3. Connect the seat switch to the machine.
4. Make sure it is securely seated.

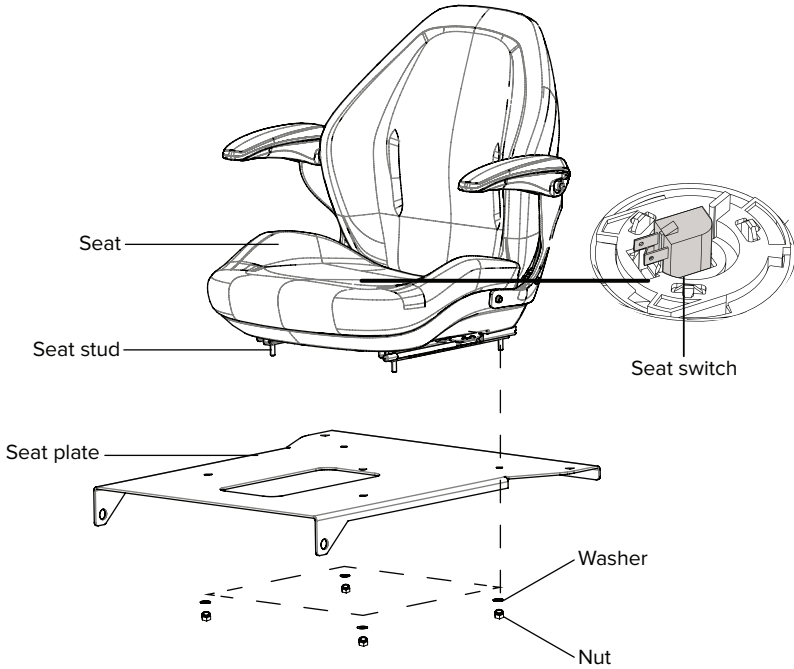

FINAL PREPARATION

CHECK TIRE PRESSURE

Check the air pressure in all tires before use. Improper air pressure will affect handling, steering response, traction, tire life, level cutting, and operator comfort. Be sure tires are inflated to the pressure shown below.

i NOTE

Tire pressure should only be measured or adjusted when tires are cold.

	Front wheel	Rear wheel
Recommended Pressure	46 psi (± 2)	10 psi (± 2)

⚠ WARNING

Check the tire pressure carefully while inflating. Too much air in the tire could cause the tire to burst, causing serious personal injury.

TEST THE SAFETY INTERLOCK SYSTEM

This mower features a Safety Interlock System to protect the operator by shutting off the blades if the operator leaves the seat with the blades running. Test the system to be sure it is working correctly.

TO TEST:

- Make sure direction control switch is in PARK position and PTO switch is down.
- Install start key and turn to "ON" position.
- Raise the PTO switch to activate blades.
- Briefly lift off the seat, but do not get off the mower.

The blades should shut off within 5 seconds. If they don't, verify you connected the seat plug to the machine. If the plug is connected but the system still doesn't function, contact customer service. Do not operate the mower until the safety interlock system has been repaired.