

Wall Scape

Slat

Sonic uniform

A series of symmetrical slats create a tidy minimalist effect. Different elevation options let you customize the aesthetic. All the serenity of being surrounded by a white picket fence.



Image by Dart Frog Creative

How To Specify

Key Information

Slat can nestle its way into your space in a variety of ways. Consider these questions as you design your layout.

If shop drawings are required for your project, please follow steps 1 - 4.

Quick Ship

If you're looking to expedite your project, this product is available as Turf Quick Ship!

Using Quick Ship, our standard lead time for shop drawings is eliminated allowing the project to move directly into production.

Please note, installation and seaming drawings are not included in this process.

Turf recommends an additional 10-15% additional panels to cover overage / attic stock.

1

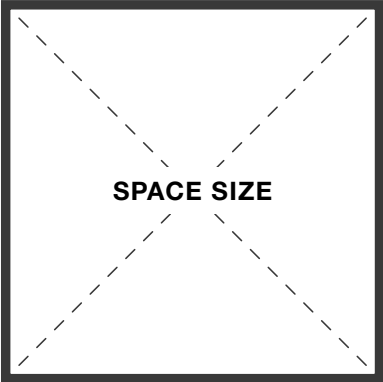

SPACE SIZE

What are the dimensions of the space?

PAGE 3

2



WALL CONNECTION

Will you use z-clips or construction adhesive by others?

PAGE 3

3

PANEL TYPE

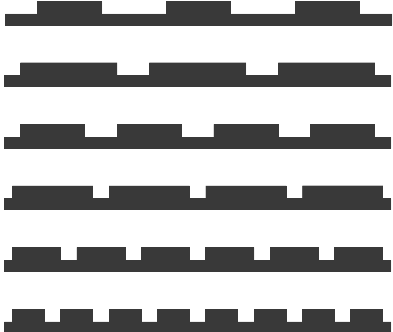

Which panel type do you need?

PAGE 4

4



COLOR

What is the color of the blades? (Primary)
What is the color of the backer? (Secondary)

PAGE 9-12



QUICK SHIP

1. Are you using z-clips or construction adhesive by others as a connection?
2. Which panel type do you need?
3. Will the panels be laid out vertical or horizontal?
4. What is the color of the blades & backer?
5. How many panels do you need?
6. Do you want to include any additional product for overage or attic stock?

Dimensions

Standard Panel	12"W x 120"L x 0.75"D
Panel Types	See our Panel Types & Connections page for more information.

Connection Options

Standard Connection	Z-Clip
Connection By Others	Construction adhesive
	Panels should be installed with construction grade adhesive specified by the contractor.

Color

9mm Palette	Slat can be specified in any of our 9mm felt colors or textures.
Color Match	Have another color in mind? Our UV printing process can match almost any hue.

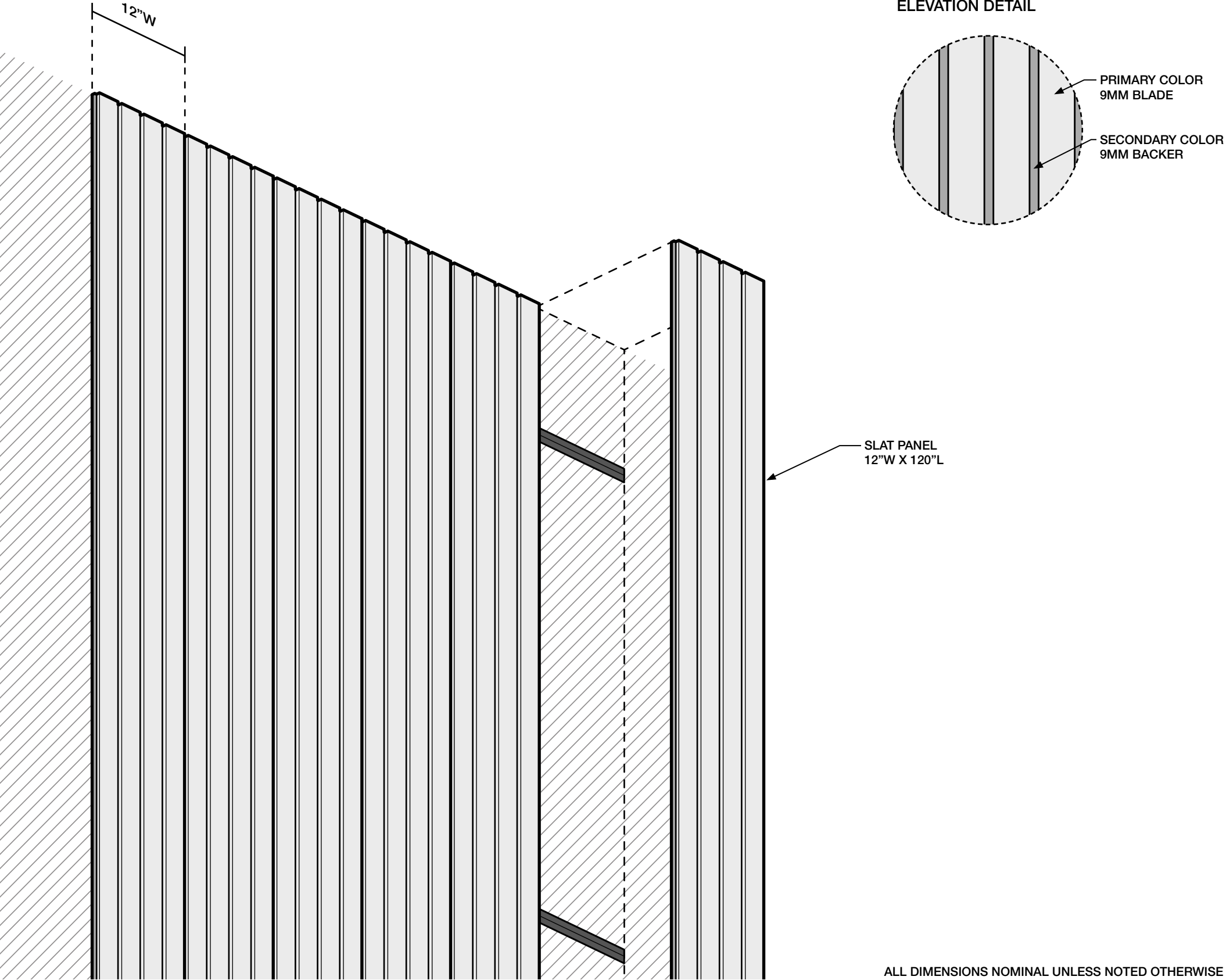

Panel Types & Connections

Number of Blades Slat panels are separated by the number of blades. Panels range from 3-8 blades.

Blade OC Spacing Blades are evenly distributed to create a seamless layout. The blade spacing ranges from 1.5"W to 4"W.

Blade Width Blade width varies based on the number of blades per panel.

Product Coordination Slat panels with 2"W blades can coordinate with the Arbor product. See Turf's website for more details.

turf.design/products/arbor

PANEL TYPES

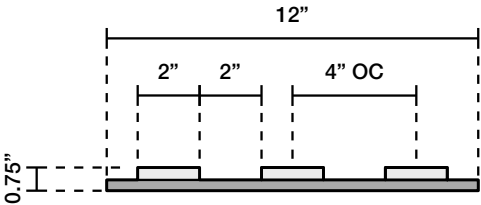

S3 - 4 - 2
3 BLADES | 4"OC | 2"W

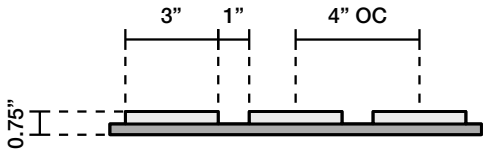

S3 - 4 - 3
3 BLADES | 4"OC | 3"W

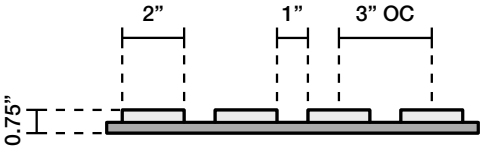

S4 - 3 - 2
4 BLADES | 3"OC | 2"W

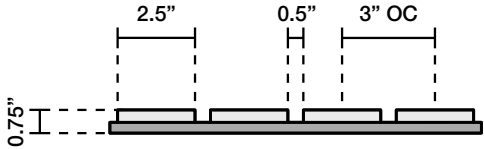

S4 - 3 - 2.5
4 BLADES | 3"OC | 2.5"W

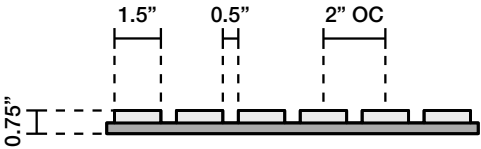

S6 - 2 - 1.5
6 BLADES | 2"OC | 1.5"W

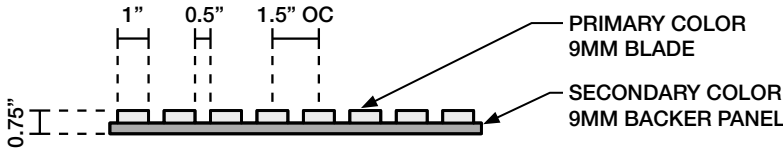

S8 - 1.5 - 1
8 BLADES | 1.5"OC | 1"W

BLADE CAP DETAIL

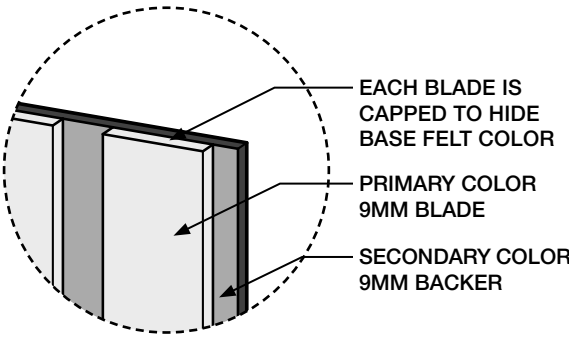

CLEARANCE DETAIL

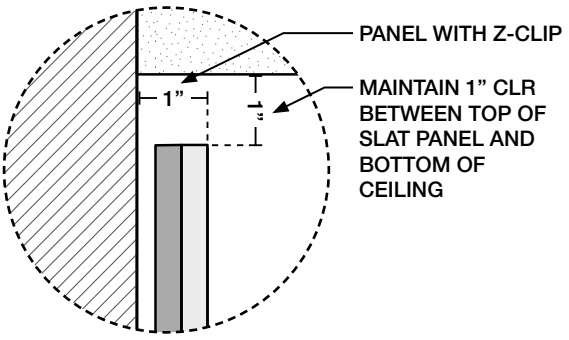

Z-CLIP WALL DETAIL

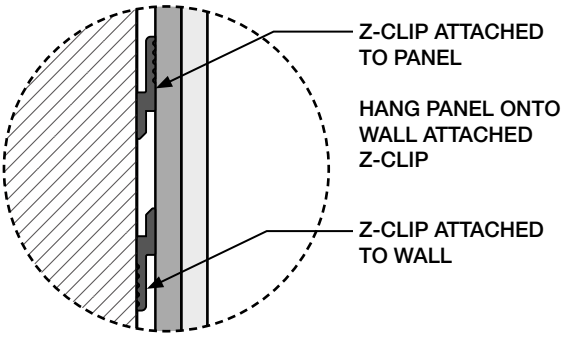

ALL DIMENSIONS NOMINAL UNLESS NOTED OTHERWISE

Panel Elevations

Elevate the Form

Choose from any panel type, then configure your layout. Each panel offers a unique option for your elevation with varying density and blade width.

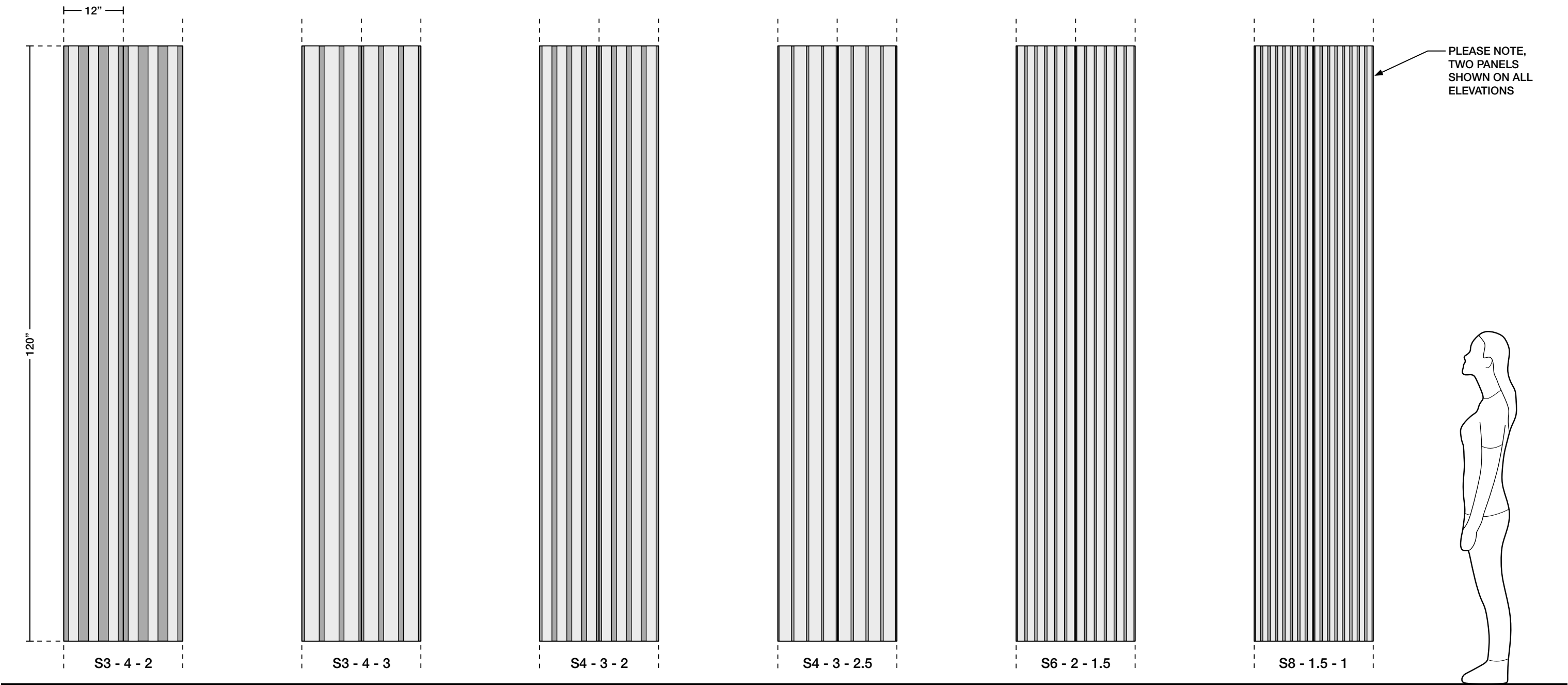

ALL DIMENSIONS NOMINAL UNLESS NOTED OTHERWISE



Typical Layouts

Wall Scape

Create a sweeping fence-like effect with Slat's Vertical Layout, or stop superfluous sound from side to side with Slat's Horizontal Layout.

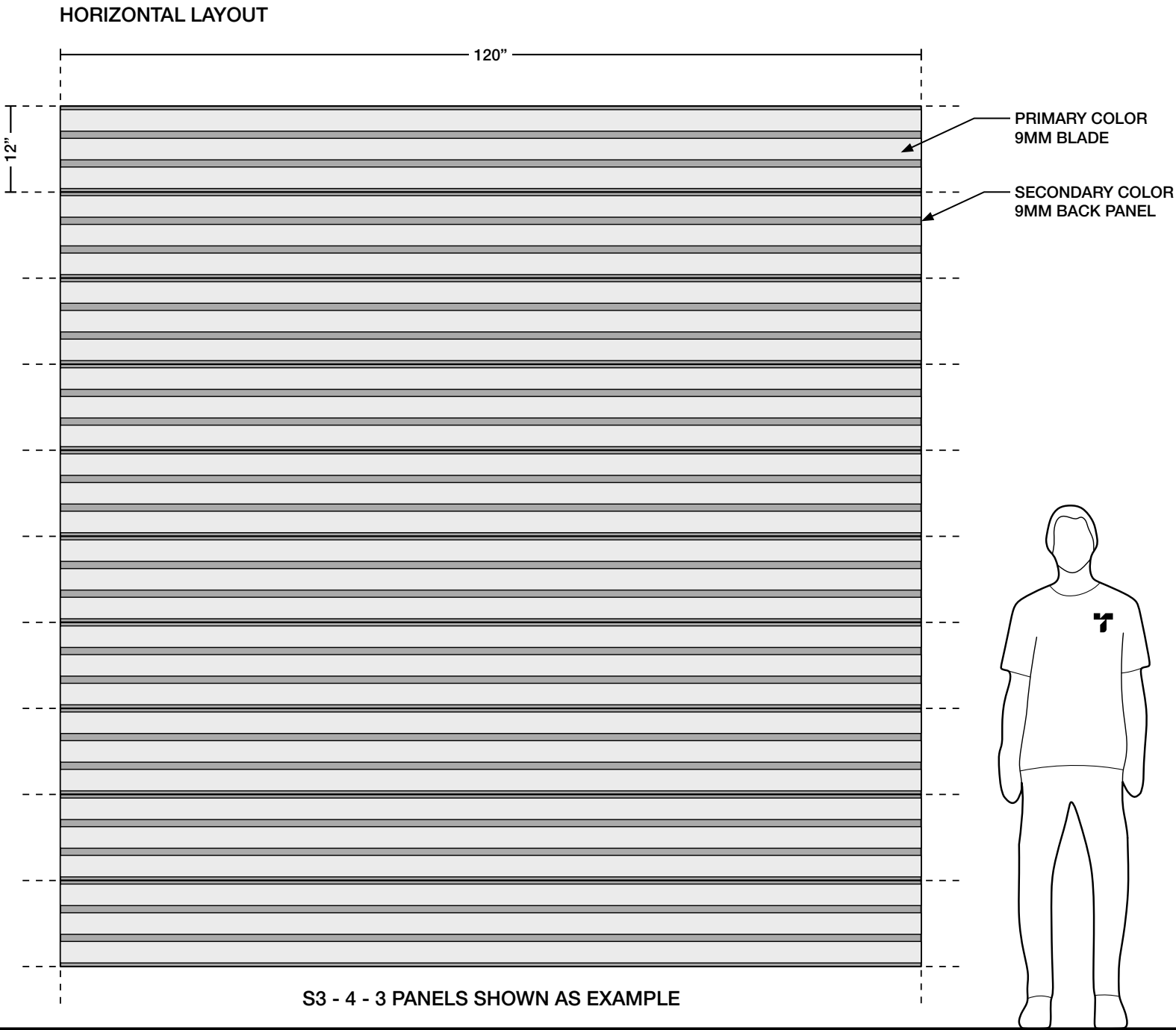
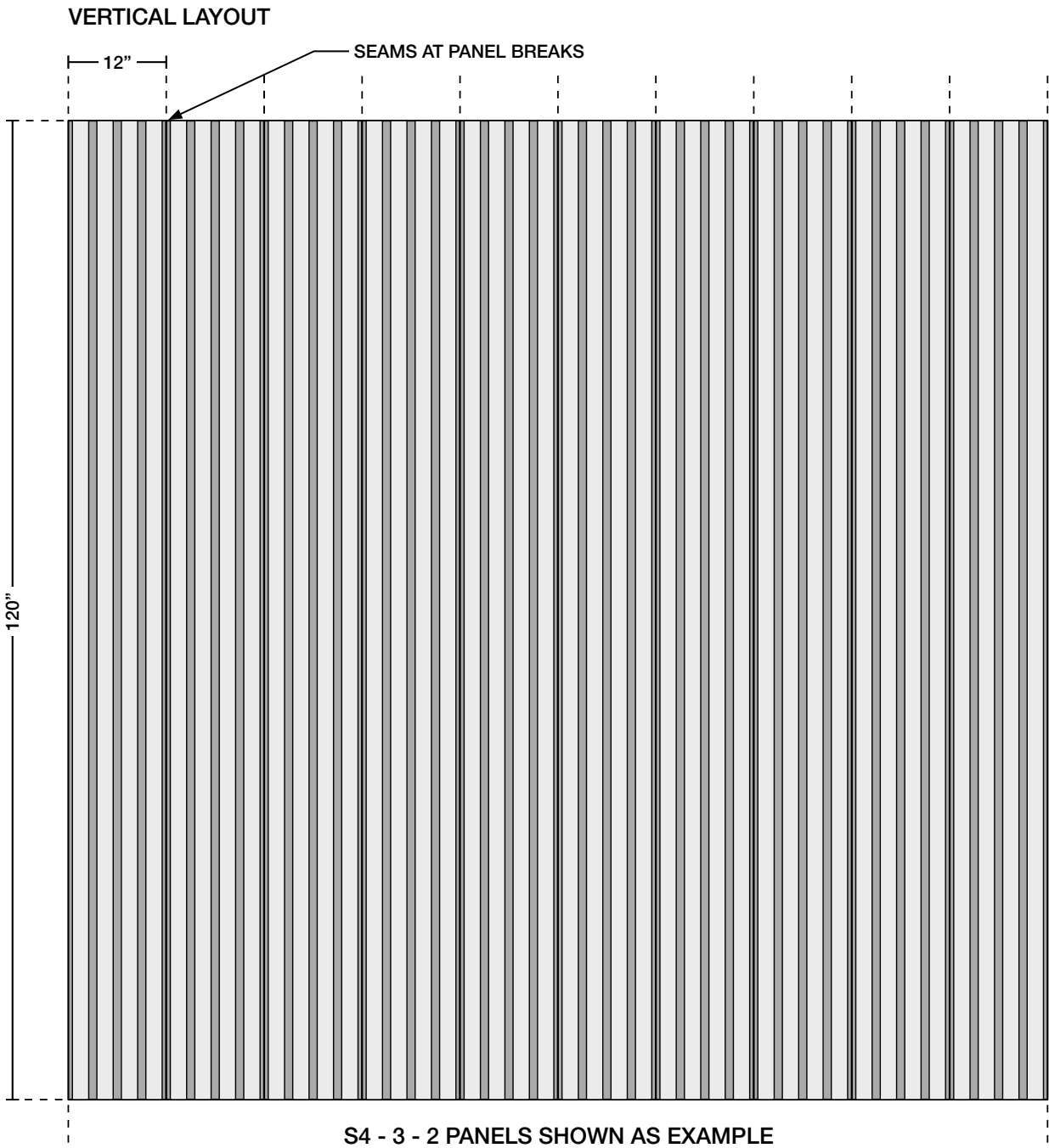

ALL DIMENSIONS NOMINAL UNLESS NOTED OTHERWISE



Installation & Trim Guide - Walls

Slat panels are designed for a quick and easily install on the wall, and can accommodate trimming in field — just follow this simple guide.

If you're using a standard z-clip connection, Turf installs 2" z-clips on the back of each Slat panel with additional runs of z-clips for mounting use by the installer.

Slat can also be requested without any additional connection hardware. Panels can be installed with construction grade adhesive specified by the contractor.

The installation instructions included are for a typical z-clip installation.

Tools Required

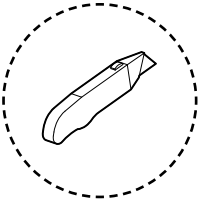

SHARP BLADE

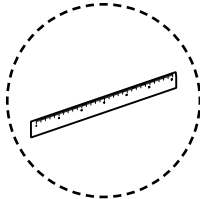

STRAIGHT
EDGE

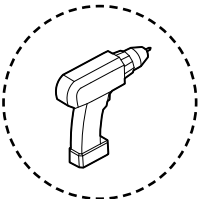

DRILL

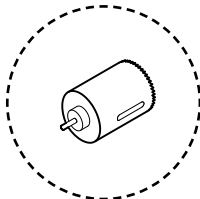

HOLE SAW

1 - ATTACH Z-CLIP TO WALL

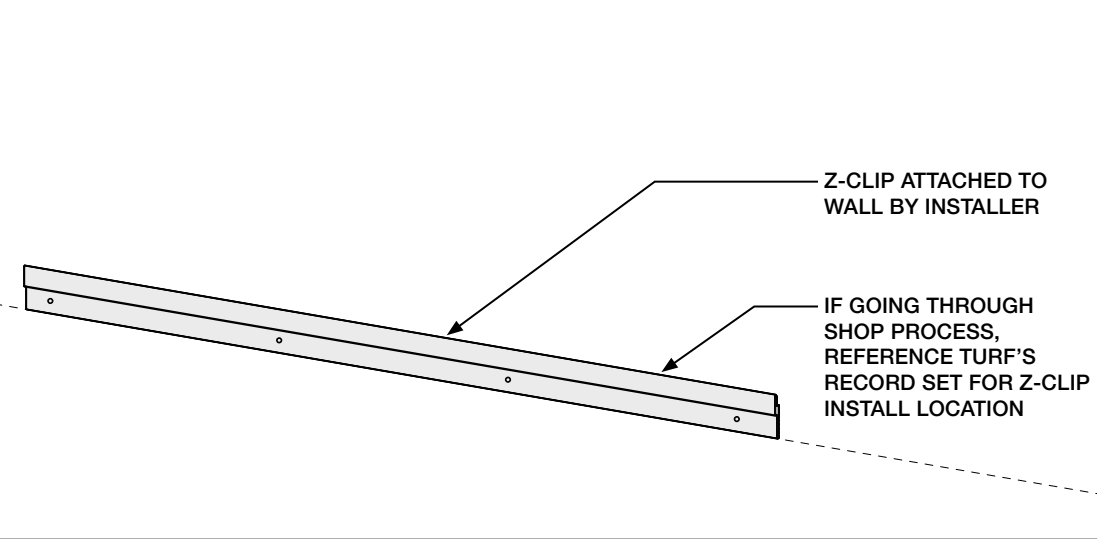

2 - MOUNT SLAT PANEL

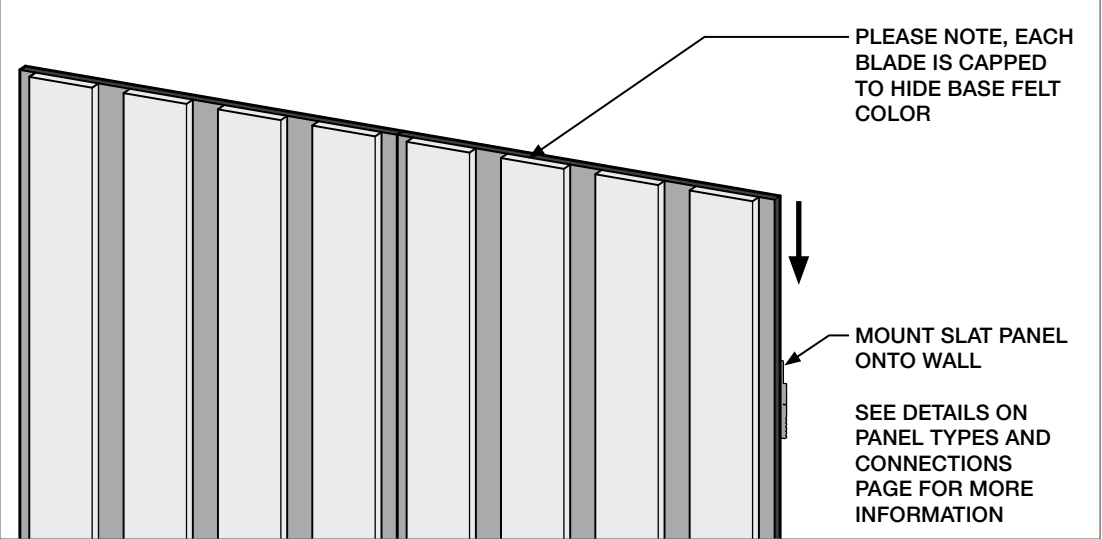

3 - TRIM HORIZONTALLY AS REQUIRED

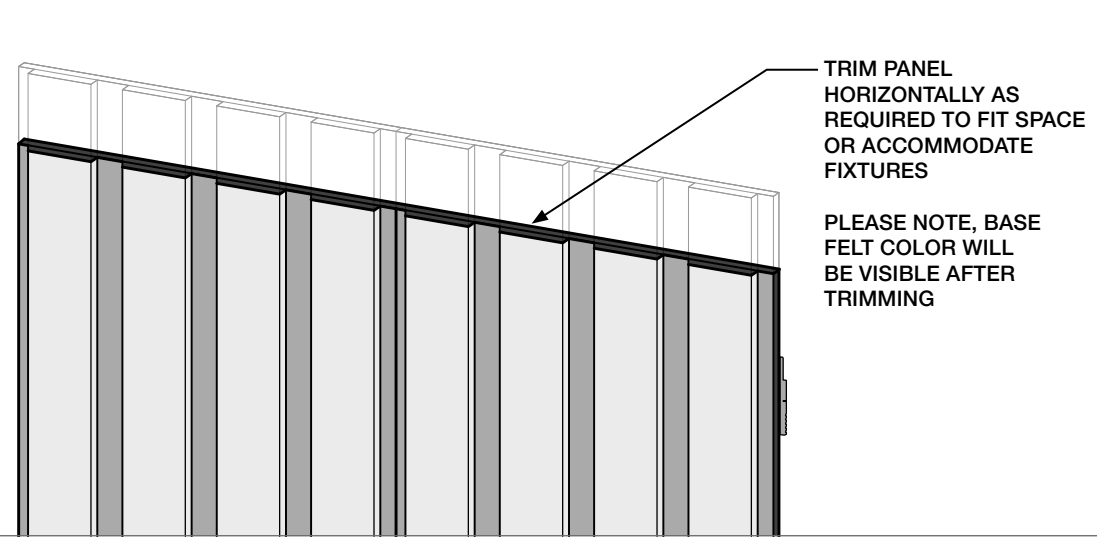

4 - TRIM CIRCULAR HOLES AS REQUIRED

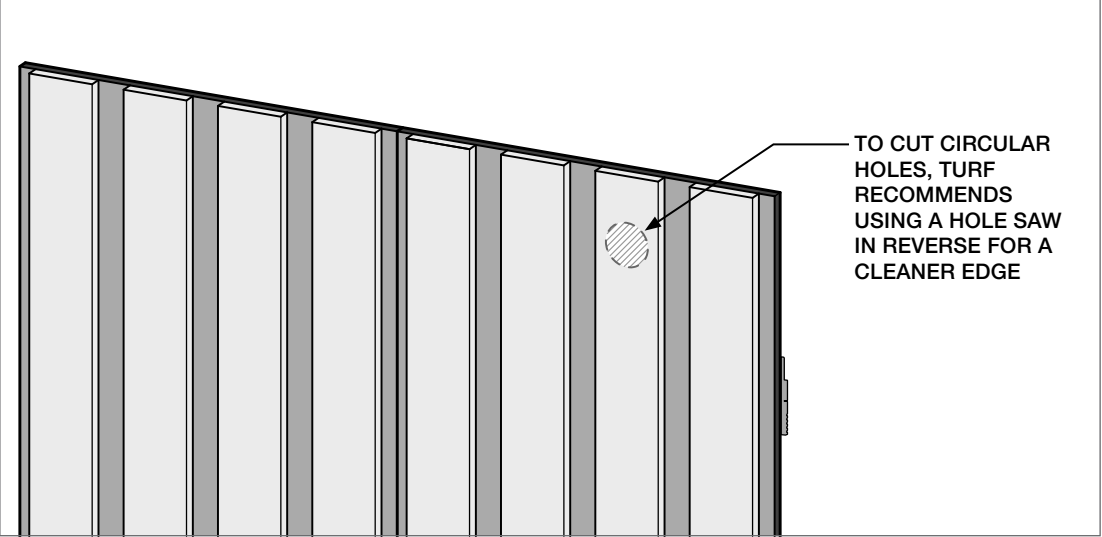

5 - TRIM VERTICALLY THROUGH BLADES AS REQUIRED

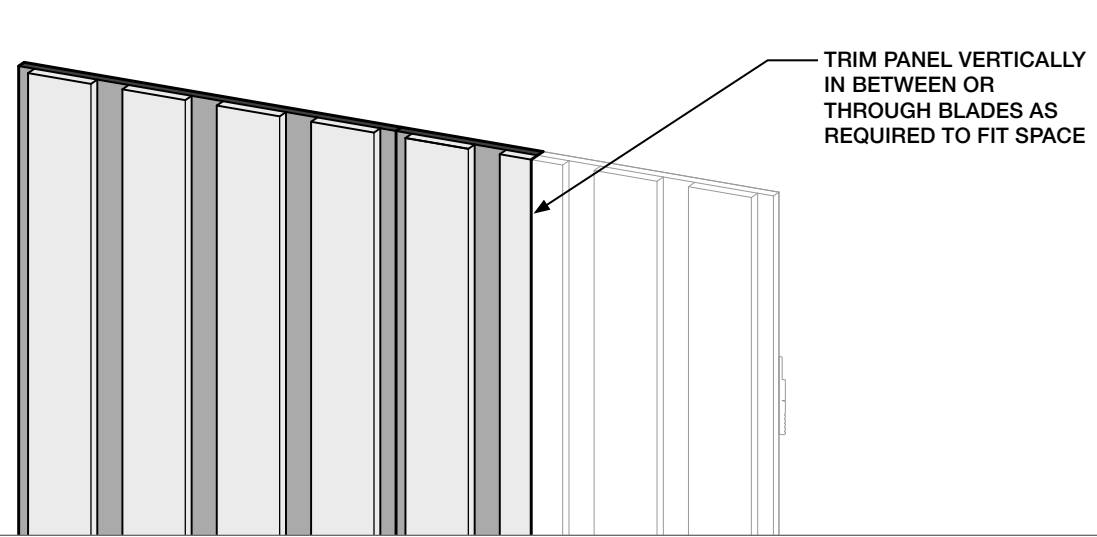

6 - SCREW THROUGH BACK OF PANEL AS REQUIRED

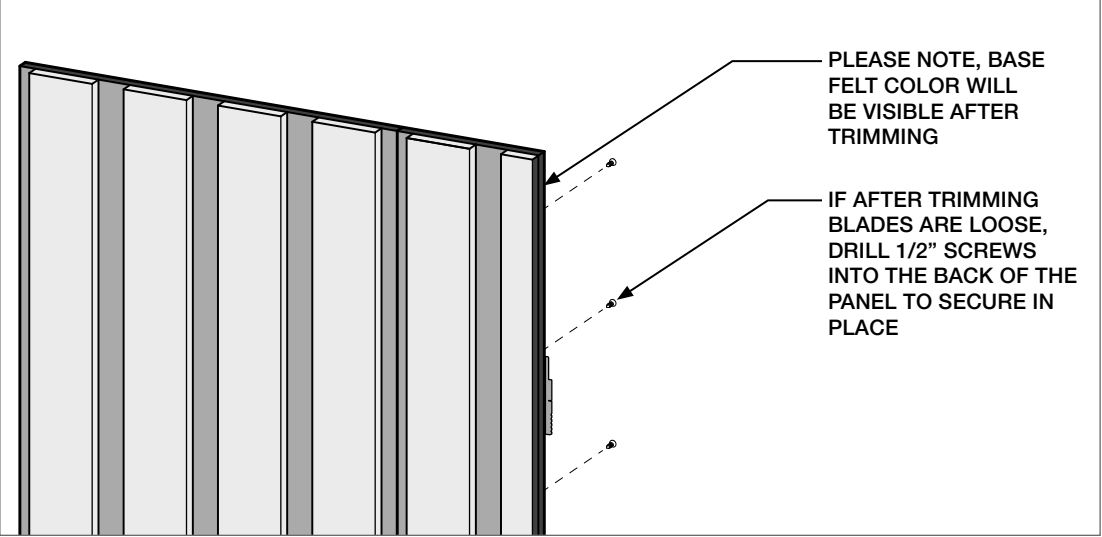

Tech

Acoustics	ASTM C423-17: Type A
Fire Rating	ASTM E-84 – Class A
VOC	ASTM D5116 Compliant

Details

Lead Time	Check the Turf website for current lead times.
Warranty	Five (5) years
Maintenance	Vacuum to remove any particulate matter and air-borne debris or dust. Compressed air can be used to dust the material in difficult to reach areas for large assemblies. Contact us for more information relative to spot cleaning.
Weight	Turf products cannot support the weight of any other items in field.

Acoustic Rating

Slat NRC	
Panel	Wall Mount
S3-4-2	0.50
S3-4-3	0.55
S4-3-2	0.55
S4-3-2.5	0.60
S6-2-1.5	0.55
S8-1.5-1	0.55

The table displays information for an 10’ x 10’ array of sound absorbing panels directly mounted to the wall.

Certifications



Image by CATK

9mm Colors

Introducing Hues, our new 9mm color palette designed for the senses.

The 9mm PET felt board is used as our primary construction material. Select one of our coordinating neutrals to blend in, or go for a contrasting element with one of our hues.

The process used to create PET felt often results in a heathered effect where multiple tones are present. Slight variations in color should be expected when using this sustainable material.

Felt Thickness
9mm +/-0.5 mm

Monitors and printers vary.
Please request a material sample to verify felt colors.



10 TOPO GREEN



12 GRASSHOPPER



11 CELADON



63 SAFFLOWER



64 PLANTAIN



43 ORANGE CRUSH



18 ULTISOL



17 BLUSH



23 RED



15 MERLOT



50 IVORY



33 LUMINARY



83 HOLLAND OATS



82 BARLEY



34 TONAL TAUPE



35 BARK



28 INDIGO



30 CYAN



24 ROYAL BLUE



31 AZURE



27 JEAN JACKET



26 FADED DENIM



40 MAGENTA



41 DRIED LAVENDER



66 PEWTER



05 WHITE



01 CREAM



04 LIGHT GREY



98 STORM



09 DAMASCUS



06 CHARCOAL



07 BLACK



9mm Wood Textures

Invite nature into your space with our wood-inspired textures. Digital printing on felt ensures a unique and realistic grain with virtually no repeats.

There is an additional product cost for Wood Textures.

Please note there is additional lead time for custom matching. Texture and customization will incur additional costs beyond our standard 9mm options.

Felt Thickness
9mm +/-0.5 mm

Monitors and printers vary.
Please request a material sample to verify felt colors.



D01 WHITE ASH



D02 SILVER TEAK



D03 CLEAR MAPLE



D04 WASHED ASH



D05 MEDIUM OAK



D06 PLANKED OAK



D07 DARK WALNUT



D08 BLACK PEAR

9mm Stone Textures

Inspired by nature, designed for felt. Our digitally printed Stone Textures capture the character and nuance of stone on top of a curated color collection from our Hues palette with virtually no repeats. The three patterns in this family each capture unique elements from the stones for which they are named.

There is an additional product cost for Stone Textures.

Turf has curated this collection to include only the best pattern and color combinations.

Felt Thickness
9mm +/-0.5 mm

Monitors and printers vary. Please request a material sample to verify felt colors.

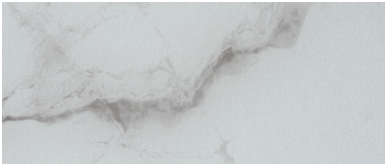

ST05 MARBLE

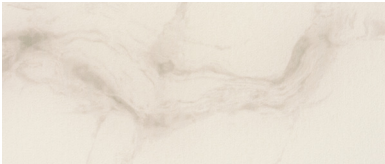

ST50 MARBLE

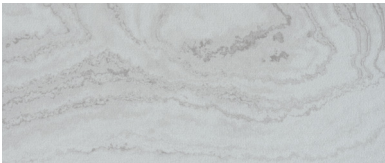

ST05 TRAVERTINE

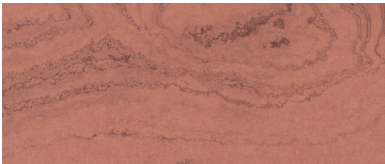

ST17 TRAVERTINE

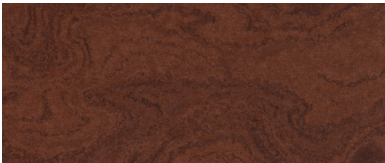

ST18 TRAVERTINE

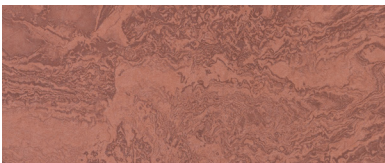

ST17 GRANITE

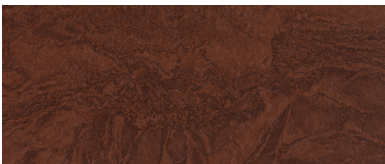

ST18 GRANITE

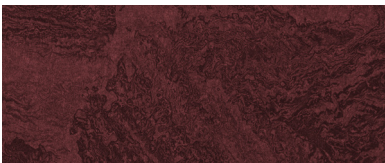

ST15 GRANITE



ST01 MARBLE

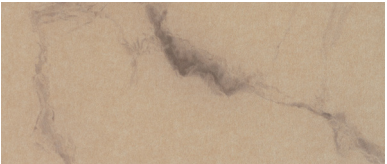

ST83 MARBLE

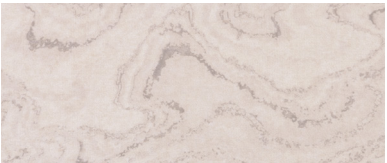

ST01 TRAVERTINE



ST83 TRAVERTINE

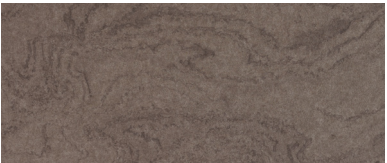

ST34 TRAVERTINE



ST34 GRANITE

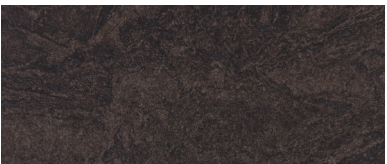

ST35 GRANITE

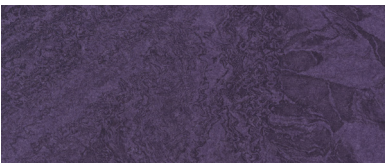

ST41 GRANITE



ST33 MARBLE

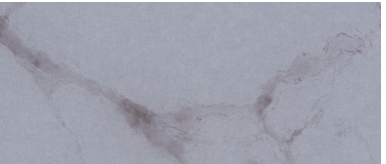

ST66 MARBLE



ST50 TRAVERTINE



ST66 TRAVERTINE

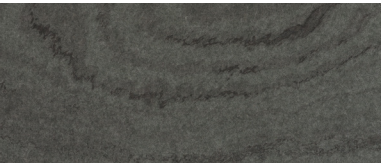

ST11 TRAVERTINE

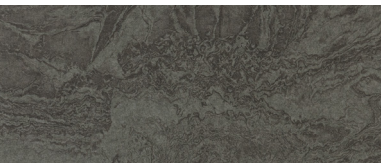

ST11 GRANITE

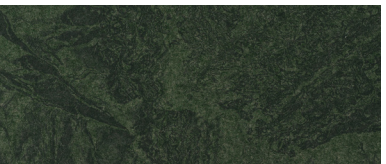

ST10 GRANITE

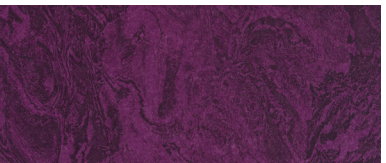

ST40 GRANITE

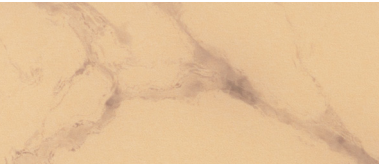

ST64 MARBLE

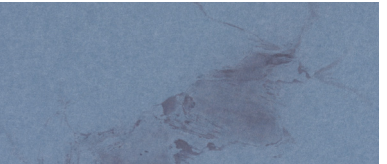

ST26 MARBLE



ST64 TRAVERTINE

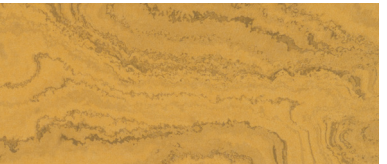

ST63 TRAVERTINE



ST26 TRAVERTINE

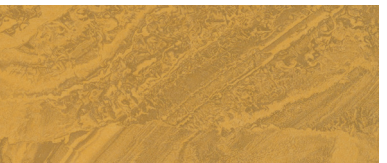

ST63 GRANITE



ST28 GRANITE



Texture & Color Pairings

These color combinations are a great starting point to pair Textures and Hues. We tested these color ways to ensure just the right amount of contrast.



D07 DARK WALNUT & 83 HOLLAND OATS



D03 CLEAR MAPLE & 11 CELADON



D05 MEDIUM OAK & 43 TONAL TAUPE



D06 PLANKED OAK & 63 SAFFLOWER



D04 WASHED ASH & 26 FADED DENIM



D02 SILVER TEAK & 15 MERLOT



D03 CLEAR MAPLE & 18 ULTISOL



D08 BLACK PEAR & 41 DRIED LAVENDER