

BOLTED-LID SIMPLEX BASKET STRAINERS

DUCTILE IRON CONSTRUCTION | PARTS & ACCESSORIES



PROTECTION FOR PUMPS & DOWNSTREAM SYSTEMS

FEATURES & BENEFITS

- Strainer bodies available in ductile iron
- Lid vent, pressure differential gauge ports, and bottom drain are all standard
- Stainless steel baskets with 3/16" perforation holes standard (no mesh)
- Basket lining available in 10, 20, 40, 60, 80 or 100 mesh
- Baskets provide maximum hoop strength to prevent distortion or basket damage
- Ductile iron can be used for steel requirements in chemical, petrochemical and pharmaceutical industries

OPTIONS

- Basket mesh from 10 to 100
- Magnetic inserts
- Differential pressure indicators

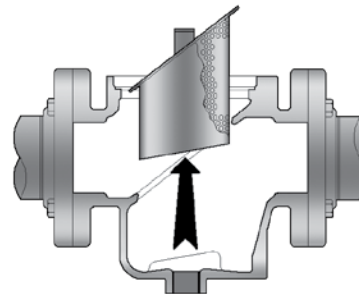
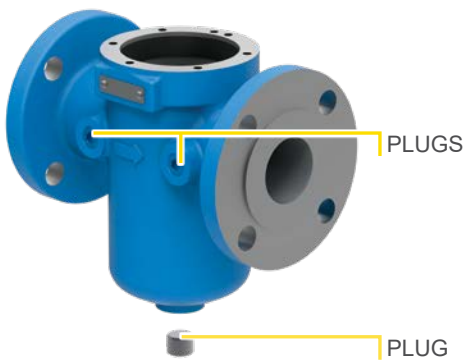
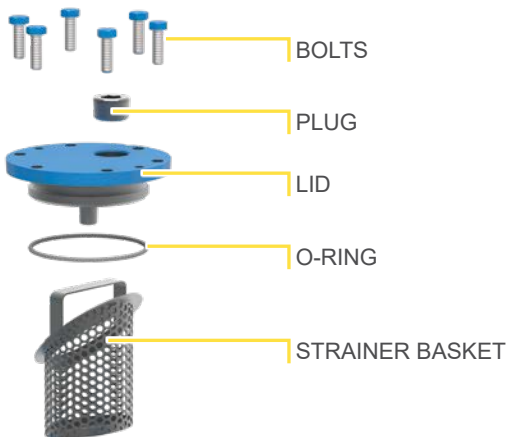

When the basket requires cleaning, simply vent system pressure, remove the lid and withdraw the basket from the top. Foreign matter contained in the basket will not drop back into the system.

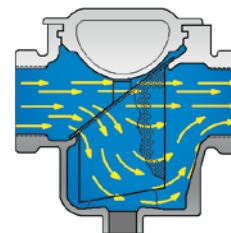

The inclined position of the strainer basket adjacent to the porting allows for smooth flow patterns.



SIZES
2", 3", 4"



MATERIALS
Ductile Iron



PORTS
Raised Face Flanges (Class 150 or Class 300)

PERFORMANCE

MODELS	SPECIFICATIONS				
	Nominal Capacity Suction Rating	Rated System Pressure	Temperature Range	Approx. Shipping Weight	Port Size
	GPM	PSI	°F	Pounds	Inches
F-1020-RDUC	100	250	0 to +350	10	2
F-1020-HDUC	100	640	0 to +350	10	2
F-1030-RDUC	200	250	0 to +350	10	3
F-1030-HDUC	200	640	0 to +350	10	3
F-1040-RDUC	400	250	0 to +350	10	4
F-1040-HDUC	400	640	0 to +350	10	4

In-line valve sold separately.

MESH SPECIFICATIONS							
MESH	NO MESH	10	20	40	60	80	100
	(Perforated Basket Only)						
OPENING (INCHES)	.188 (Sizes 2" - 4")	0.075	0.034	0.015	0.009	0.007	0.0055
OPENING (MICRONS)	4775 (Sizes 2" - 4")	1,910	860	380	230	190	140



Strainer shown with optional pressure differential indicator



Baskets shown with optional magnetic inserts to trap fine ferrous particles

VIKING QUALITY CONSTRUCTION

- High-quality, easy-to-clean simplex strainers
- Designed for chemical, petrochemical and most general fluid-flow applications
- Raised face flanges available for 2, 3 & 4 inch piping
- SS basket and screen are available in no mesh, 10, 20, 40, 60, 80 or 100 mesh
- Nominal capacities range from 100 to 400 GPM
- Pressures up to 640 PSI
- Strainer bodies and lids are available in ductile iron

LOW PRESSURE DROP

Viking Bolted-Lid Strainers are designed for minimal pressure drop through the unit. Pressure drop is minimized by the inclined position of the strainer basket adjacent to the porting. This provides smooth flow patterns not found in conventional basket type strainers.

EASY TO CLEAN

No special tools are needed for lid removal. Once bolts are removed with a standard wrench, lid is lifted to open the cover. The basket is removed from the top of the strainer to eliminate foreign matter from dropping back into the line when the strainer is cleaned. These strainers are equipped with a bottom drain plug for complete draining.

VIKING PUMP®

VIKING PUMP, INC.
A Unit of IDEX Corporation
406 State Street
Cedar Falls, Iowa 50613 U.S.A.
vikingpump.com

CONTACT YOUR STOCKING DISTRIBUTOR TODAY

GLOBAL LEADER IN POSITIVE DISPLACEMENT PUMPING SOLUTIONS: Cedar Falls, Iowa, USA | Windsor, Ontario, Canada | Shannon, Ireland | Eastbourne, United Kingdom

IDEX

© Copyright 2021 Viking Pump, Inc. All Rights Reserved. Rev0721 | Form No. 1987