

BG Diesel Induction Service

Operating Instructions for Ford Power Stroke 6.7L DI

BG Ford 6.7L EGR System Service Adaptor, PN 9255-049
and BG Ford 6.7L EGR System Service Plug, PN 9255-050

Always clean EGR passages before cleaning air intake. For use with BG Diesel Induction Service Set, PN 9255-550.

1. Add one quart (946 mL) of BG 245,[®] PN 24532, to fuel tank.
2. Check computer for diagnostic codes and record them. Clear the codes.
3. Locate and remove the exhaust manifold to EGR tube. This tube delivers exhaust gases to the EGR Valve.
4. Bolt the BG Ford 6.7L EGR System Service Plug, PN 9255-050, on the exhaust manifold where exhaust manifold to EGR tube was removed. The EGR system service plug will keep exhaust gasses from coming out of exhaust manifold.
5. Bolt the BG Ford 6.7L EGR System Service Adaptor, PN 9255-049, to the EGR. The BG Ford 6.7L EGR System Service Adaptor, will allow for the BG 1Q VIA[®] supply tool and BG Injector Atomizer to be attached to the EGR valve.
6. Locate the connection in the air tube that runs from the turbo to the plenum. Separate the tube and install the BG Universal Diesel Intake Adaptor over the metal tube on the engine side. Center the adaptor using the thumb screws. Insert BG Aluminum Plug Assembly, PN 9255-034. Remove vent plug.
Important! Do not skip this step!
7. Install the BG Injector Atomizer to the BG Ford 6.7L EGR System Service Adaptor. The adaptor

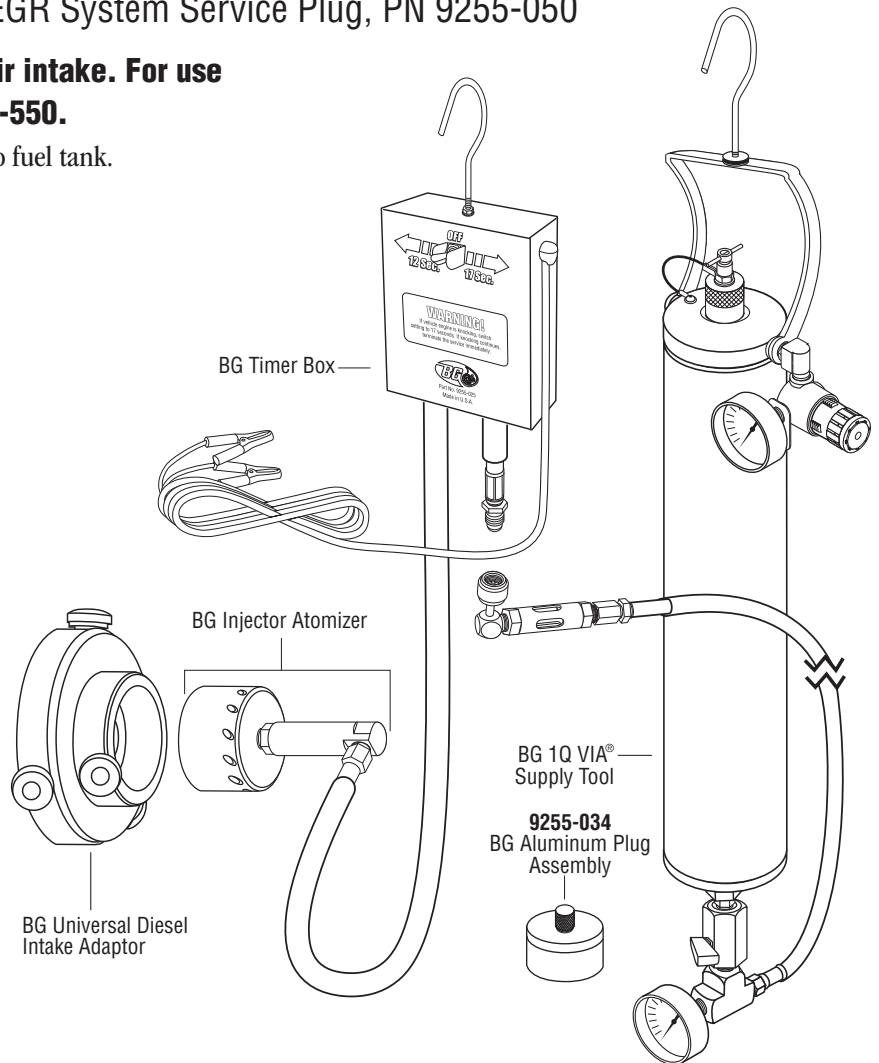

Install BG Universal Intake Adaptor and BG Injector Atomizer that is bolted to EGR valve.

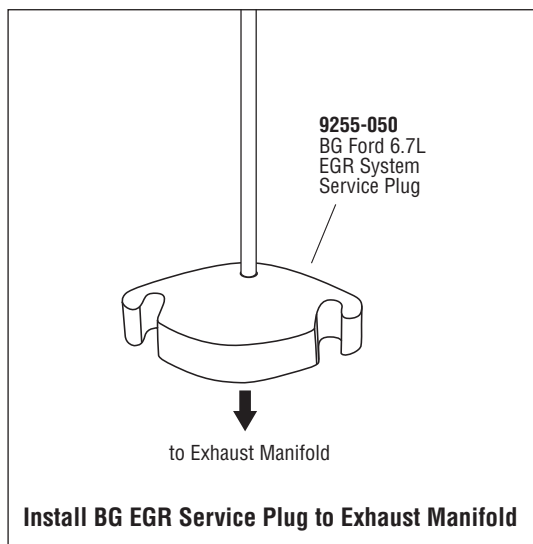

8. Close all valves on the BG 1Q VIA[®]. Fill the BG 1Q VIA[®] with one quart (946 mL) of BG Diesel ISC,[®] PN 25532. Close fill cap securely and connect the supply hose from the BG 1Q VIA[®] to the bottom of the BG Timer Box. Connect BG 1Q VIA[®] to air supply and set regulator pressure to 90 PSI.
9. Make sure the switch on the BG Timer Box is set to "Off." Connect to 12-volt DC power supply. Many diesels are 24-volt systems; be sure you have a 12-volt source.

WARNING! Ensure RED cable clamp is connected to positive (+) battery terminal and BLACK cable clamp is connected to negative (-) battery terminal. Improper use will result in engine failure!

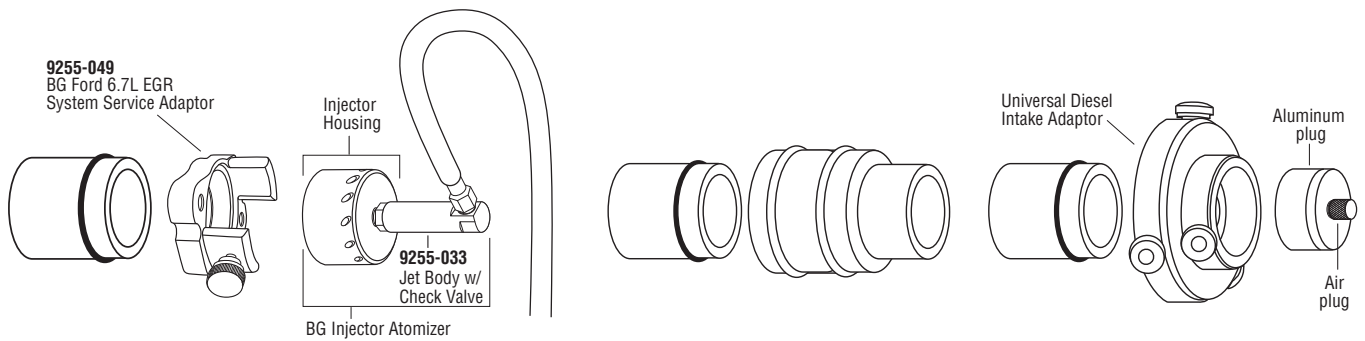

Install BG Injector Atomizer into BG Ford 6.7L EGR System Service Adaptor

Separate Air Tube

Connect BG Universal Diesel Intake Adaptor

- Start engine and bring to full operating temperature. Use throttle depressor to set RPM between 900–1000. Use diagnostic scan tool to command the EGR valve open. Open ball valve on BG 1Q VIA™ and turn BG Timer Box to the highest number, which will give the longest time between firings. If the vehicle runs well and does not clatter or knock, switch to the lower number for a faster cleaning setting.

NOTE: If the engine begins to clatter or knock, immediately turn off the BG Timer Box and wait for the engine to run normally. Restart service by setting selector to highest number. If vehicle bellows black smoke, decrease engine RPM. If vehicle continues to bellow black smoke, do not proceed with service.

- During this stage of the service the EGR valve should remain open until the entire quart (946 mL) of BG Diesel ISC® has been consumed.

NOTE: Diagnostic scan tool will be needed to command the EGR valve open.

- When cleaning is complete, shut engine off. Be sure to turn the BG Timer Box off and shut off the ball valve on BG 1Q VIA.™ Remove the BG Injector Atomizer from the BG Ford 6.7L EGR System Service Adaptor.

Cleaning Air Intake

- Remove Aluminum Plug Assembly, PN 9255-034, from Universal Diesel Intake adaptor located at the air intake. Put the aluminum plug assembly into the BG Ford 6.7L EGR System Service Adaptor. This will block off the EGR valve.

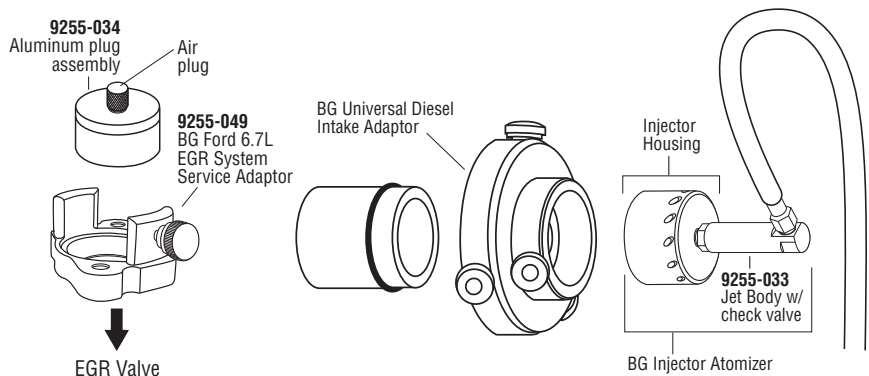

Install Aluminum Plug

Install BG Injector Atomizer into BG Universal Diesel Intake Adaptor

- Install the BG Injector Atomizer to the Universal Diesel Intake adaptor located at the air intake.

- Refill the BG 1Q VIA® with one quart (946 mL) of BG Diesel ISC® Seal and pressurize the BG 1Q VIA™ to 90 PSI.

- Start engine and bring to full operating temperature. Use throttle depressor to set RPM between 900–1000. Open ball valve on BG 1Q VIA™ and turn BG Timer Box to the higher number, which will give the longest time between firings. If the vehicle runs well and does not clatter or knock, switch to the lower number for a faster cleaning setting.

NOTE: If the engine begins to clatter or knock, immediately turn off the BG Timer Box and wait for the engine to run normally. Restart service by setting selector to higher number. If vehicle bellows black smoke, decrease engine RPM. If vehicle continues to bellow black smoke, do not proceed with service.

- Restart engine, raise RPM between 1500–2000 for 15 minutes to dry out pockets of cleaner that may have accumulated. **Do not skip this step!**

- Install one quart (946 mL) of BG EPR® Engine Performance Restoration,® PN 10932, in the crankcase of the engine. This step will clean the oil passages and help restore compression.

- Engine oil and filter will be contaminated with cleaning solution from the service and must be changed at this time. Failure to do so will result in engine damage.

- Add one quart (946 mL) of BG DOC® Diesel Oil Conditioner, PN 11232, to new engine oil.