

BG Diesel Induction Service

Operating Instructions for Chevrolet Duramax 6.6L DI

BG '07 and Newer Duramax Adaptor, PN 9255-046

Always clean EGR passages before cleaning air intake. For use with BG Diesel Induction Service Set, PN 9255-550.

1. Add one quart (946 mL) of BG 245,[®] PN 24532, to fuel tank.
2. Check computer for diagnostic codes and record them. Clear the codes.
3. Locate and remove the Manifold Absolute Pressure (MAP) sensor. The MAP sensor is located on the air intake inlet of the engine.
4. Locate the connection in the air tube that runs from the turbo to the plenum. Separate the tube and install the BG Universal Diesel Intake Adaptor over the metal tube on the engine side. Center the adaptor using the thumb screws. Install just the BG Injector Housing to the BG Universal Diesel Intake Adaptor. Note: This is required to create a vacuum.

NOTE: Some Chevrolet 6.6L DI engines do not have a MAP sensor located on the air intake inlet. If there isn't a MAP sensor, use set up from step 4 and proceed to step 12 of the cleaning instructions.

5. Connect the BG '07 and Newer Duramax Adaptor, PN 9255-046, to the Jet Body with Check Valve, PN 9255-033.
6. Install the BG '07 and Newer Duramax Adaptor, using the bolt from the MAP sensor.
7. Close all valves on the BG 1Q VIA[®] supply tool. Fill the BG 1Q VIA[®] with one quart (946 mL) of BG Diesel ISC,[®] PN 25532. Close fill cap securely and connect the supply hose from the BG 1Q VIA[®] to the bottom of the BG Timer Box. Connect BG 1Q VIA[®] to air supply and set regulator pressure to 90 PSI.

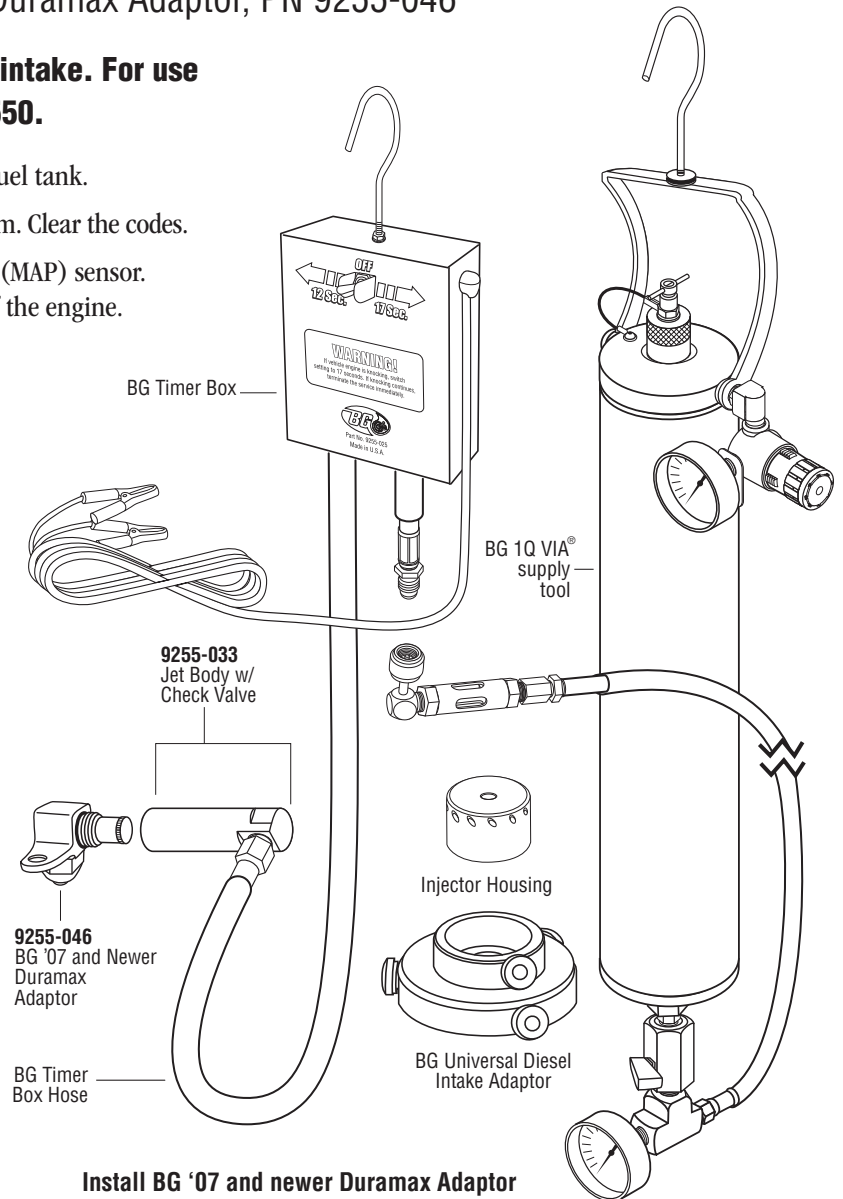
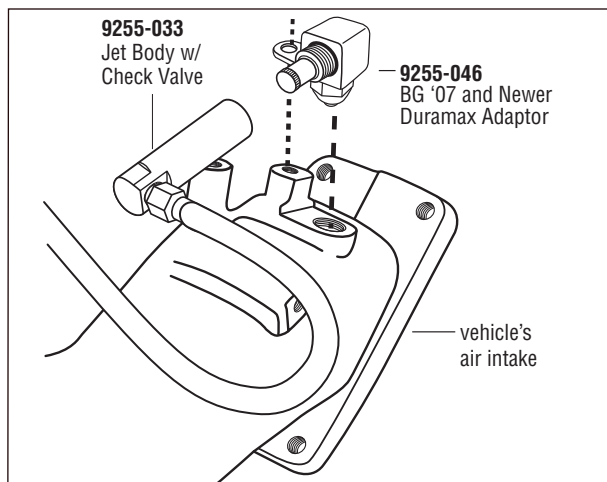

Install BG '07 and newer Duramax Adaptor

8. Make sure the switch on the BG Timer Box is set to "Off." Connect to 12-volt DC power supply. Many diesels are 24-volt systems; be sure you have a 12-volt source. **WARNING! Ensure that RED cable clamp is connected to positive (+) battery terminal and BLACK cable clamp is connected to negative (-) battery terminal. Improper use will result in engine failure!**
9. Start engine and bring to full operating temperature. Use throttle depressor to set RPM between 900–1000. Open ball valve on BG 1Q VIA[®] and turn BG Timer Box to the highest number, which will give the longest time between firings. If the vehicle runs well and does not clatter or knock, switch to the lower number for a faster cleaning setting.

(continued on back)

NOTE: If the engine begins to clatter or knock, immediately turn off the BG Timer Box and wait for the engine to run normally. Restart service by setting selector to highest number. If vehicle bellows black smoke, decrease engine RPM. If vehicle continues to bellow black smoke, do not proceed with service.

- During this stage of the service the EGR valve should be cycled open and closed several times. Cycling the valve open and closed will help clean the valve.

NOTE: Diagnostic scan tool will be needed to cycle the EGR valve open and closed.

- When cleaning is complete, shut engine off. Be sure to turn the BG Timer Box off and shut off the ball valve on the BG 1Q VIA®. Remove the BG '07 and Newer Duramax Adaptor, and reinstall the MAP sensor.

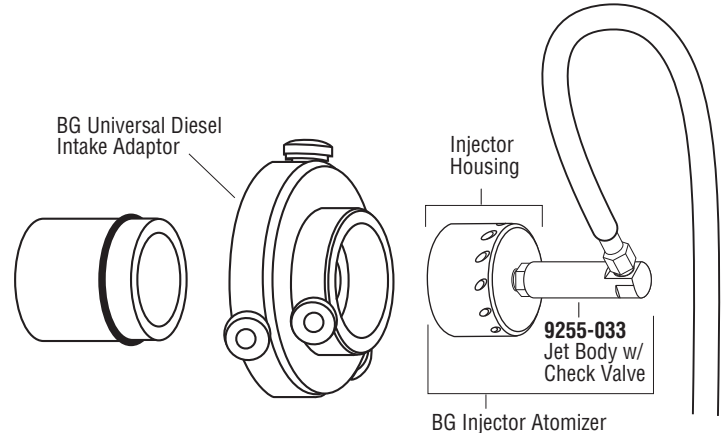

Install BG Injector Atomizer into BG Universal Diesel Intake Adaptor

Cleaning AirIntake

- Connect the Injector Housing to the BG Jet Body with Check Valve, PN 9255-033.
- Refill the BG 1Q VIA® with one quart (946 mL) of BG Diesel ISC.® Seal and pressurize the BG 1Q VIA® to 90 PSI.
- Start engine and bring to full operating temperature. Use throttle depressor to set RPM between 900–1000. Open ball valve on BG 1Q VIA® and turn BG Timer Box to the highest number, which will give the longest time between firings. If the vehicle runs well and does not clatter or knock, switch to the lower number for a faster cleaning setting.

NOTE: If the engine begins to clatter or knock, immediately turn off the BG Timer Box and wait for the engine to run normally. Restart service by setting selector to highest number. If vehicle bellows black smoke, decrease engine RPM. If vehicle continues to bellow black smoke, do not proceed with service.

- When the BG Diesel ISC® has been consumed, shut engine off and remove all apparatus. Reconnect air tube to the intake.
- Restart engine, raise RPM between 1500–2000 for 15 minutes to dry out pockets of cleaner that may have accumulated.
Do not skip this step!
- Install one quart (946 mL) of BG EPR® Engine Performance Restoration,® PN 10932, in the crankcase of the engine. This step will clean the oil passages and help restore compression.
- Engine oil and filter will be contaminated with cleaning solution from the service and must be changed at this time. Failure to do so will result in engine damage.
- Add one quart (946 mL) of BG DOC® Diesel Oil Conditioner, PN 11232, to new engine oil.
- Clear any codes that may have been set.
- Drive the vehicle for 5–10 miles to remove any loose deposits.