

# Downhole Ball-Drop Tool

## Pre-loaded Ball Carrier for Downhole Tool Integration

The downhole ball-drop tool provides the ability to run downhole tools with the activation ball carried in-line above the target ball seat. This enables ball activated tools to be deployed in otherwise non-viable scenarios, or for multiple operations to be combined into a single run to improve overall operating time.

Used in conjunction with other downhole tools that require a ball for activation, the ball-drop tool carries the ball into the well and will drop the ball when a predetermined flow rate is exceeded.

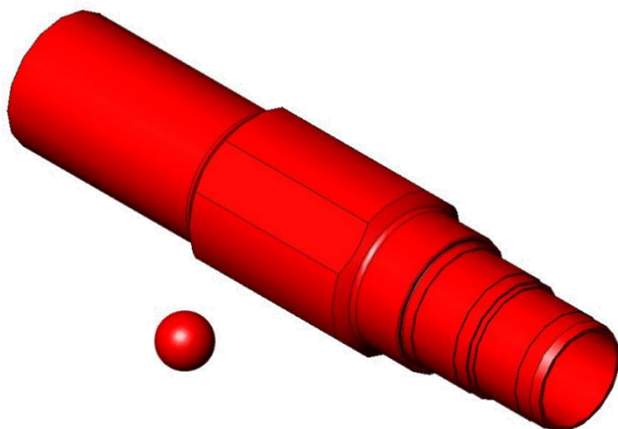

*Downhole ball-drop tool*

The tool provides the ability to unlock a broader range of operating scenarios for a number of ball activated tools. Jobs previously unworkable due to equipment limitations or ID restrictions in the work string may now be performed by integrating the downhole ball-drop tool into the BHA

It is available in 2.25" and 3.25" ODs and may be configured with the following drop ball options.

BHA OD	Drop Ball Diameter Ranges
2.25"	0.50" - 0.625"
3.25"	0.50" - 0.875"

For more information, contact your local Halliburton representative or visit us on the web at [www.halliburton.com](http://www.halliburton.com)

Sales of Halliburton products and services will be in accord solely with the terms and conditions contained in the contract between Halliburton and the customer that is applicable to the sale.

© 2020 Halliburton. All Rights Reserved

## APPLICATIONS

- » Firing head activation for perforating
- » Setting/retrieving packers, plugs, retainers, or straddles
- » Providing ability to disconnect lower sections of tool strings

## BENEFITS

- » Ensures ball reaches target for improved reliability of downhole actuation
- » Enables a ball larger than the minimum ID in the tool string to be used
- » Minimizes fluid volume required to circulate a ball to a tool
- » Cuts job time by eliminating the need to circulate a ball through the entire coiled tubing string
- » Ability to combine multiple operations into fewer runs by allowing tools to be run in tandem tool configurations

## FEATURES

- » Adjustable to drop ball at different flow rates
- » Can be configured for different ball sizes
- » Compact, simple design