

# Capillary Suction Timer Model 441

## Instruction Manual



**Manual No. 204217, Revision G**

**Instrument No. 103115155**

**Capillary Suction Timer Instruction Manual**

©2013 Fann Instrument Company

**fann**<sup>®</sup>  
Fann Instrument Company

Houston, Texas, USA

All rights reserved. No part of this work covered by the copyright hereon may be reproduced or copied in any form or by any means (graphic, electronic, or mechanical) without first receiving the written permission of Fann Instrument Company, Houston, Texas, USA.

Printed in USA.

The information contained in this document includes concepts, methods, and apparatus which may be covered by U.S. Patents. Fann Instrument Company reserves the right to make improvements in design, construction, and appearance of our products without prior notice.

FANN® and the FANN logo are registered trademarks of Fann Instrument Company in the United States and/or other countries. All other trademarks mentioned in the operating instructions are the exclusive property of the respective manufacturers.

## Contact FANN



### Phone

TELEPHONE: 281-871-4482  
TOLL FREE: 800-347-0450  
FAX: 281-871-4358



### Mail

Fann Instrument Company  
P.O. Box 4350  
Houston, Texas, 77210 USA



### Location

Fann Instrument Company  
14851 Milner Road, Gate 5  
Houston, Texas, 77032, USA



### Online

[www.fann.com](http://www.fann.com)  
[fannmail@fann.com](mailto:fannmail@fann.com)

## Table of Contents

1	Introduction .....	4
1.1	Document Conventions .....	5
2	Safety.....	6
3	Features and Specifications .....	7
4	Test Procedure.....	8
5	Troubleshooting and Maintenance .....	12
5.1	Battery Replacement.....	12
6	Parts List.....	13
7	Warranty and Returns .....	14
7.1	Warranty .....	14
7.2	Returns .....	14

## List of Figures

Figure 3-1	Capillary Suction Timer.....	7
Figure 4-1	Test Head and Sensor Tray.....	9
Figure 4-2	Capillary Suction Timer Funnel.....	10

## List of Tables

Table 6-1	Capillary Suction Timer, Model 441, P/N 103115155.....	13
-----------	--	----

## 1 Introduction

The Capillary Suction Timer, Model 441 measures the filtration rate of free water in a fluid. The instrument contains a control cabinet that houses a timer and connects to the test head with electrodes. Fluid will contact and penetrate a thick, special grade paper (test blotter paper) that sits between the acrylic plates of the test head. This fluid will travel outward from a circular spot and will reach the nearest electrical contact on the sensor plate. It will continue to spread until it reaches the next electrical contact. The Capillary Suction Timer measures the time it takes for the fluid to spread from the first electrical contact to the second contact. This time is measured in 1/10 seconds.

The Capillary Suction Timer consists of the following:

- Cabinet — controls, batteries, and connection for the test head (acrylic unit)
- Test Head — sensor plate (on top) with pins and cable connection into the instrument cabinet and the sensor tray (bottom)
- Test Blotter Paper
- Funnel
- 9VDC battery
- Battery Eliminator, 115 VAC



This instrument may be operated from its self-contained 9 volt battery for field use, or from 115V, 60 Hz power. The 115 volt adapter when plugged into the instrument will operate it. This adapter will not charge the batteries.

---

### 1.1 Document Conventions

The following icons are used as necessary in this instruction manual.



**NOTE.** Notes emphasize additional information that may be useful to the reader.



**CAUTION.** Describes a situation or practice that requires operator awareness or action in order to avoid undesirable consequences.



**MANDATORY ACTION.** Gives directions that, if not observed, could result in loss of data or in damage to equipment.



**WARNING!** Describes an unsafe condition or practice that if not corrected, could result in personal injury or threat to health.



**ELECTRICITY WARNING!** Alerts the operator that there is risk of electric shock.



**HOT SURFACE!** Alerts the operator that there is a hot surface and that there is risk of getting burned if the surface is touched.



**EXPLOSION RISK!** Alerts the operator that there is risk of explosion.

## 2 Safety

Safe laboratory practices and procedures should be observed while operating and maintaining the Capillary Suction Timer. This section lists some precautions to follow.

If the instrument will be used on 115 volt AC power, plug the transformer into and AC receptacle and the jack into the back of the instrument case marked EXTERNAL POWER.



---

Make sure the transformer and cable to the Capillary Suction Timer are in good condition. Plugging a defective device into 115 volts can cause electrical shock.

---

### 3 Features and Specifications

The Capillary Suction Timer, Model 441 consists of a control cabinet with a digital timer, test head, funnel (sample cell), test blotter paper, and 5-ml syringes. See Figure 3-1 and Table 6-1.

The control cabinet functions are as follows:

<b>POWER ON</b>	Green ON
<b>POWER OFF</b>	Red OFF
<b>SET/RESET</b>	Green Right Arrow Key Set/ Reset timer to 0.0



Figure 3-1 Capillary Suction Timer

## 4 Test Procedure

If the instrument will be used on 115 volt AC power, plug the 12V AC/DC adapter into an AC/DC jack as indicated in the below picture.

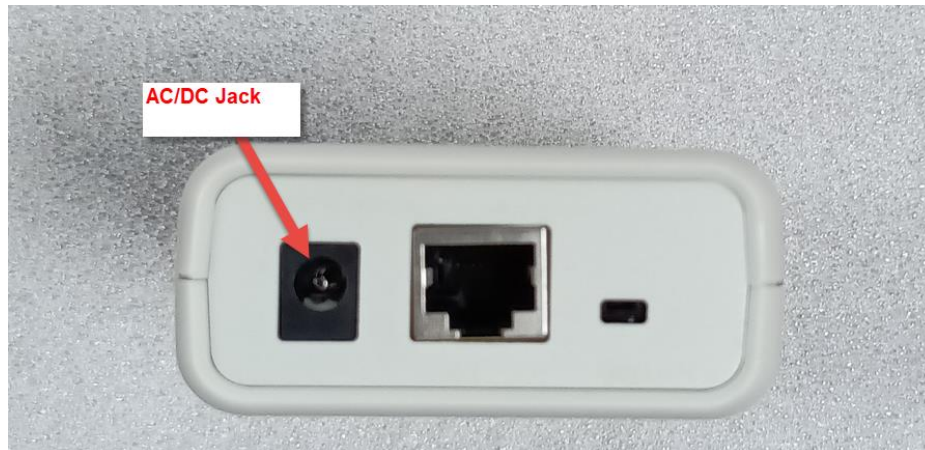

Make sure the transformer and cable to the Capillary Suction Timer are in good condition. Plugging a defective device into 115 volts can cause electrical shock.

1. Clean and dry the sensor tray and sensor plate.
2. Plug the sensor plate assembly into the RJ45 connector shown in the below picture.

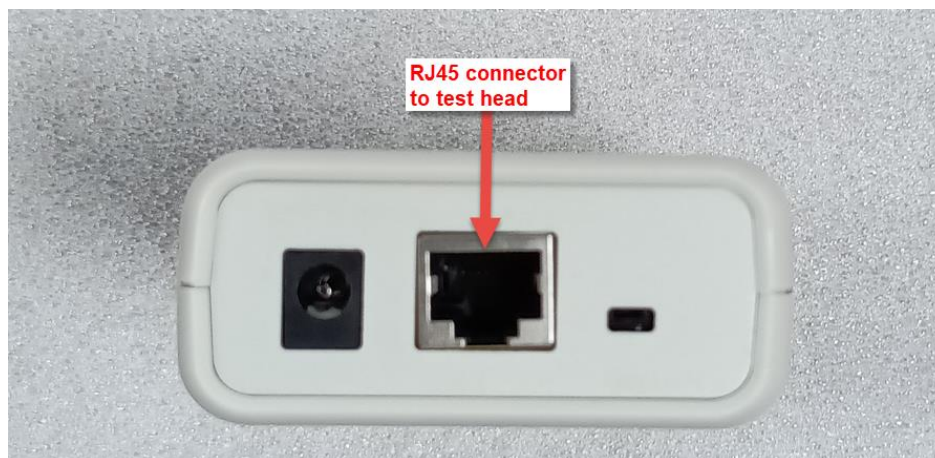



3. Place test blotter paper on top of the sensor tray and under all three pins as shown in Figure 4-1. Place the sensor plate, probe side down on top of the test blotter paper, engaging the two alignment pins.

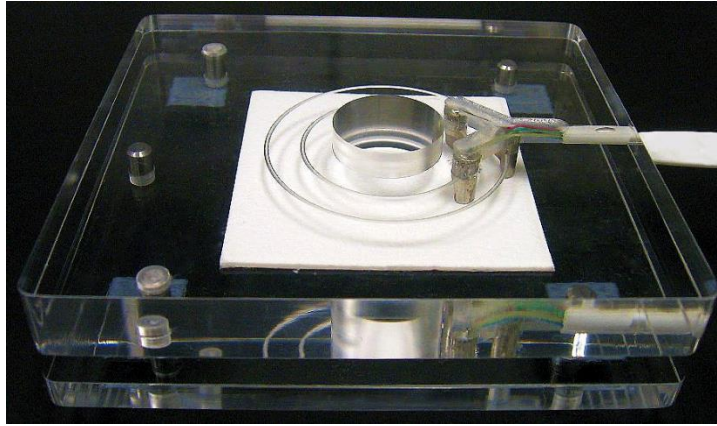

**Figure 4-1 Test Head and Sensor Tray**



---

The test blotter paper is large enough to extend beyond the sensor pins and the scribed sensor area on the sensor head. Refer to Figure 4-1.

---

4. Select appropriate funnel diameter and insert it into the test head. Choose either of these sizes:
  - a. 1 cm (0.394 in.) diameter funnel opening for fast filtering systems
  - b. 1.8 cm (0.708 in.) diameter funnel opening for slow filtering systems

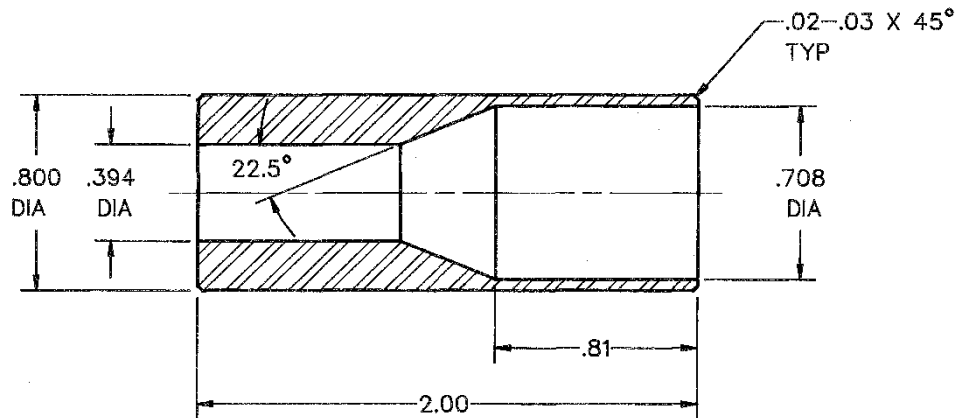

**Figure 4-2 Capillary Suction Timer Funnel**

5. Rotate the funnel, applying light downward pressure when in position to ensure even contact with the test blotter paper.
6. Depress the green power ON button. The screen will initially display the firmware version and then will cycle to the Time screen.
7. For the first test, you will need to depress the green right arrow button one time to set the timer to 0.0 seconds.
8. Use a syringe to place approximately 5 ml of sample into the funnel. Liquid from the sample is absorbed by the test blotter paper in a circular pattern of increasing diameter.
9. When the liquid front reaches the first pair of contacts, the counter starts, the timing begins.
10. When the liquid front reaches the third contact, timing ceases, the counter stops, and the final timer value will be displayed.



The counter reading which is the capillary suction time in second and tenth of seconds, and the funnel opening used 1.0 cm or 1.8 cm.

11. Remove the funnel and test blotter paper.
12. Clean and dry sensor plate, sensor bottom, and funnel. For additional measurements, repeat the procedure.
13. Depress the red power switch to turn the unit off. If you want to run another test, then the green right arrow key should be depressed which will reset the timer to 0.0 seconds.

NOTE: The following message will appear once the battery has low voltage.



## 5 Troubleshooting and Maintenance

Troubleshooting and regular maintenance procedures are described in this section. If more extensive maintenance or service of the instrument is required, please contact Fann Instrument Company.

Keep the test head clean and dry.

Occasionally clean the probes by drawing the block carefully with a slight downward pressure over the test blotter paper laid on a flat surface.

### 5.1 Battery Replacement



---

Proper installation is important. Place the battery in the drawer with the terminals as shown in the bottom of the drawer.

---

The battery should be removed if the instrument will be stored for a long time..

Replace the battery with new 9-volt alkaline batteries (P/N 205643) or equal whenever the LOW BAT light appears.

- The battery is accessed from the back of the Capillary Suction Timer.



- Lift and remove the battery drawer.
- Remove the bad battery.
- Place a new battery in the drawer with terminals to the open end, plus (+) battery terminal to the left as shown in the bottom of the drawer.
- Replace the drawer in the instrument.

## 6 Parts List

**Table 6-1 Capillary Suction Timer, Model 441, P/N 103115155**

<b>Part No.</b>	<b>Quantity</b>	<b>Description</b>
103115145	1	CONTROLLER, CAPILLARY SUCTION TIMER
209707	1	TEST HEAD ASSEMBLY
209709	1	SENSOR TRAY ASSEMBLY
204217	1	INSTRUCTION MANUAL
205235	2	SYRINGE, 5 ML DISPOSABLE W/O NEEDLE
206059	1	TEST BLOTTER PAPER, 100/BOX
209710	1	FUNNEL
209998	1	BATTERY ELIMINATOR, 115V

## **7 Warranty and Returns**

### **7.1 Warranty**

Fann Instrument Company warrants its products to be free from defects in material and workmanship for a period of 12 months from the time of shipment. If repair or adjustment is necessary, and has not been the result of abuse or misuse within the twelve-month period, please return, freight prepaid, and correction of the defect will be made without charge.

Out of warranty products will be repaired for a nominal charge.

Please refer to the accompanying warranty statement enclosed with the product.

### **7.2 Returns**

For your protection, items being returned must be carefully packed to prevent damage in shipment and insured against possible damage or loss. Fann will not be responsible for damage resulting from careless or insufficient packing.

Before returning items for any reason, authorization must be obtained from Fann Instrument Company. When applying for authorization, please include information regarding the reason the items are to be returned.

Our correspondence address is:

**Fann Instrument Company**

P.O. Box 4350

Houston, Texas USA 77210

Telephone: 281-871-4482

Toll Free: 800-347-0450

FAX: 281-871-4446

Email [fannmail@fann.com](mailto:fannmail@fann.com)

Our shipping address is:

**Fann Instrument Company**

14851 Milner Road, Gate 5

Houston, Texas 77032