



BATH FITTER®

CARING FOR YOUR NEW BATH FITTER UNIT

GENERAL CARE

PLUMBING & VALVE INFORMATION

TUB & SHOWER DOOR INFORMATION

FOR QUESTIONS CALL OUR WARRANTY DEPARTMENT

1-888-448-7250

or email warranty@bathsaver.com



CARING FOR YOUR NEW BATH FITTER UNIT

Thank you for choosing Bath Fitter and making a major investment in your home! We are proud of our product and completely committed to providing you with the best service possible.

We recommend you read this manual carefully before using your bath or shower for the first time. It contains valuable information on how to properly maintain and care for your Bath Fitter system. We know you'll enjoy your Bath Fitter unit for years to come, and we hope you consider us for future needs.

IMPORTANT:

CLEANING YOUR SILICONE

Please do not clean the silicone on your new Bath Fitter system for **A MINIMUM OF 7 DAYS**. Chemicals can retard the silicone's mold-resistant properties.

MAINTAIN:

After each use, pat dry with a towel.

VENTILATE:

Let your bathroom breathe by ventilating with a fan or opening a window in the bathroom.

CLEAN:

Use Clorox Clean-Up Cleaner with Bleach (follow instructions on the bottle) to treat any affected areas until the issue resolves itself. Rinse cleaner off thoroughly after use.

The silicone may also be cleaned regularly with a 50/50 mix of water and regular chlorine bleach which will help to kill any germs and/or bacteria lying on the surface.

An environmentally friendly solution of water and white vinegar will also do a great job of eliminating mildew on silicone and is cost effective.

CLEANING YOUR ACRYLIC

It is recommended to remove such things as soap residue from your tub/shower unit and silicone areas by cleaning with an approved cleaner. Regular cleaning will keep your new unit looking great for years to come. Always rinse any cleaning product off the acrylic surfaces immediately. Bath Fitter regularly re-tests these products to ensure the ingredients have not changed. It is recommended you contact the Warranty Department regularly at 1-888-448-7250 or warranty@bathsaver.com to see if any products have been added or removed from this list.

Note: All products must be used as directed on their labels, including diluting with water when necessary.

Caution: Many manufacturers make similarly named products. ONLY the specifically named products listed here have been tested and determined to be safe. Unapproved cleaners used on our products can cause damage and therefore void our warranty. ONLY use the approved cleaners below.

Always rinse any cleaning product off the acrylic surfaces immediately.

- Clorox Clean Up Cleaner with Bleach
- Scrub-Free Lemon Scent with Oxi-Clean
- Tilex Mildew Remover
- Lime-A-Way-Lime, Calcium and Rust Cleaner
- Lysol All Purpose Cleaner-with Bleach
- Soft Scrub with Bleach
- Simple Green-Lime Scale Remover
- Formula 409 Orange Power
- Vinegar - Pure White
- Bar Keepers Friend Spray Foam

TIPS

- When using the Dobie pad (made by Scotch Brite) for cleaning, it is important to always use water with the Dobie pad so as not to mar the acrylic finish. The Dobie pad should only be used on the textured tub or shower bottom.
- We highly recommend using body wash instead of bar soap. Bar soap contains a hardening agent that will leave visual residue in the unit.



TIPS FOR CLEANING SHOWER DOORS

- Use Bar Keepers Friend Spray Foam to clean the shower door thresholds on your bypass or pivot shower door. It also works great on fixtures. Rinse thoroughly when done.
- Clean the shower doors after every use to keep them looking new. **We strongly recommend using a squeegee to clean off glass shower doors after each use.**
- Hard water stains can be cleaned with Lime-A-Way by Reckitt Benckiser, found in most major grocery and hardware stores. A white vinegar solution can also be used.
- Soap scum and hard water stains can be removed from shower doors with a ½ cup of white vinegar and a ½ cup of water. Spray on and let sit for a few minutes, then rinse with warm/hot water. (Note that this will leave a slight odor but it will go away after a couple of uses.)
- Spray glass with Rain-X or Protect All to avoid water spotting (using instructions on the bottle). Clean surface prior to application.
- Use shampoo on the glass. Any shampoo will do. Cover a rag or sponge with a generous amount of shampoo and rub on the glass door. You don't even have to scrub! Press firmly with a few passes, wait about 30 seconds and rinse.
- Clean any mold or mildew buildup with an approved bleach cleaner (see approved cleaner list).
- **Caution:** Never use a scouring agent to clean the hardware or the glass.
- **Please note:** Any of these tips may need to be repeated if necessary depending on the amount of buildup. These tips should ONLY be applied to the glass on the doors, not to the finish of the doors.

BATH SALTS

Use of baking soda, epsom salt, bath salts, or bleach baths is not recommended, but if used, the unit must be *thoroughly* rinsed immediately to prevent pitting.

HAIR DYE

Hair dyes will stain many surfaces, including acrylic. Using hair dyes is NOT recommended, but if used, the unit must be *thoroughly* rinsed immediately.

TOBACCO

Tobacco smoke may discolor your Bath Fitter unit and is NOT recommended.

CANDLES

To avoid burning the acrylic, as well as discoloration of the silicone, do not use candles in or around your tub or shower.

TENSION BARS

We do not recommend the use of tension curtain rods or tension corner caddies due to safety concerns. The use of tension rods may also void the warranty.

DRILLING

DO NOT drill anything into the acrylic surfaces, as it could void the warranty.

BATH BOMBS

Due to the results of a study we conducted with over 15 different bath bomb products, we do not recommend the use of bath bombs with your Bath Fitter unit.

AEROSOL SPRAYS

The use of any type of aerosol spray will result in irreparable damage to the acrylic surface and will void the warranty.

ESSENTIAL OILS

Use of personal care products or cleaning products based on essential oils are not recommended and can cause irreparable damage to the acrylic surface and void the warranty.

IMPORTANT

While you may use your tub unit, please refrain from using the shower for 24 hours after the installation. This allows adequate time for the silicone adhesive to cure.

CAUTION: It is well known that wet, soapy surfaces can be slippery. Please be extremely careful when bathing. The application of a Bath Fitter slip resistant coating to your tub or shower floor is available as an option. If you did not choose this option at time of sale, please contact the Warranty Department at 1-888-448-7250 or warranty@bathsaver.com for more information and pricing options.

SERVICING

If service is needed on your Bath Fitter unit, contact the Warranty Department at any time at 1-888-448-7250 or warranty@bathsaver.com. Attempting to service the unit on your own could result in voiding the warranty.

PLUMBING & VALVE INFORMATION

CLEANING THE DRAIN

It is recommended you clean hair and debris out of the pop-up stopper if you notice the water is taking longer than normal to drain. Use the easy-to-follow instructions for removal of the pop-up stopper.

REMOVING THE POP-UP STOPPER

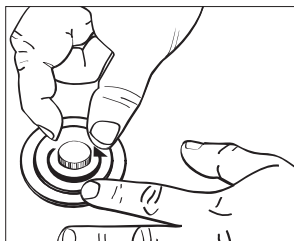

Push the stopper down. Then, while holding stopper down, unscrew and remove knob.

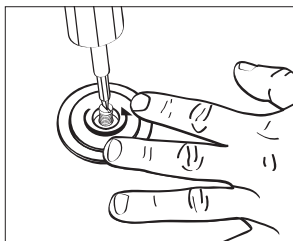

Unscrew brass screw. Use flathead screwdriver if necessary.

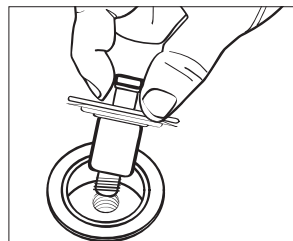

Remove stopper assembly and clean drain, then reinstall assembly.

UNCLOGGING THE DRAIN

PLEASE NOTE: The use of any chemical drain cleaners such as Drano, Liquid Plumr, etc., will result in irreparable damage to the acrylic surface and WILL VOID THE WARRANTY.

To free up a clogged drain, remove the pop-up stopper and verify it is not clogged with hair. If necessary, a flexible plastic drain stick (e.g. Zip-It) can be inserted in the drain to help remove hair from the drain. If not clogged by hair, fill the bottom of the bathtub with approximately 1" of water and use a plunger. If you notice that there is not enough suction to free up the clog because air is passing through the overflow, use a wet wash cloth to cover the overflow and continue to plunge drain as normal.

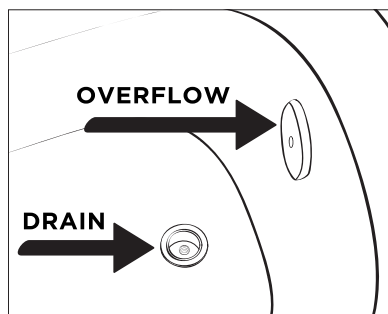

If the previous steps do not unclog your drain, refer to the Troubleshooting Guide (pages 10 and 11) for specific instructions.

If these methods fail, it may be necessary to call a plumber.

USING YOUR DELTA FIXTURES

Manufacturers change styles and model types, so depending on the year of installation, you may have one of the fixtures below.

The **classic shower head** has three different settings for water flow. To change the water settings, simply move the lever on the right side of the shower head to the desired water flow setting.

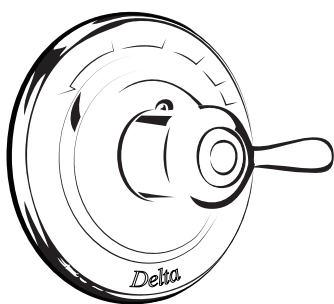
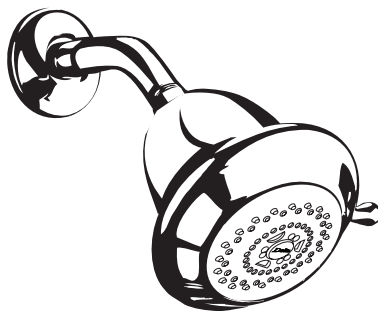

The **single handle fixture** controls both the water temperature and the water pressure.

The **diverter** found on the **tub spout** is used to divert water from the tub spout up to the shower head. To divert the water to the shower head, turn the water on and pull up on the diverter located on the top of the tub spout. Once this is done, water should be completely flowing from the shower head. (A small amount of water dripping out of the tub spout while shower head is in use is normal.)



Once the water is turned off, it is safe to tap the diverter back down if it does not drop down on its own. **(Note: Always be sure the water is off. Do not force diverter back down.)**

USING YOUR SPEAKMAN FIXTURES

Manufacturers change styles and model types, so depending on the year of installation, you may have one of the fixtures below.

The **classic shower head** has three different settings for water flow. To change the water settings, simply rotate your fixture's Anystream mechanism to your desired water flow setting.

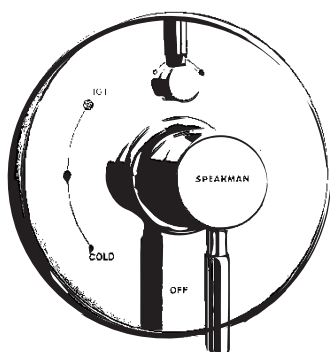
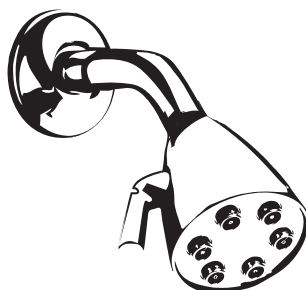

The **single handle fixture** controls both the water temperature and the water pressure.

The **diverter** found on the **single handle fixture** is used to divert water from the tub spout up to the shower head. To divert the water to the shower head, turn the water on and turn the diverter handle located on the top of the single handle fixture plate. Once this is done, water should be completely flowing from the shower head. (A small amount of water dripping out of the tub spout while shower head is in use is normal.)



CLEANING YOUR DELTA OR SPEAKMAN FIXTURES

A mild paste or liquid car wax can be rubbed on the fixtures to allow an extra protective coating for homes with hard water or water softeners.

TUB & SHOWER DOOR INFORMATION

PROPER CLOSED DOOR POSITION

The design of the tub/shower bypass doors requires that the inner door be closed at the fixture end of the unit (as shown in Figure 1) so that water does not spray between the glass panels and onto the bathroom floor (as shown in Figure 2).

SECURITY BAR

The security bars have beauty rings covering the wall anchors. The anchors are sealed under the beauty rings to prevent water from penetrating behind the wall. These rings are for aesthetic purposes only and a certain amount of movement is normal.

PERSONAL SPRAYER

All personal sprayers come with a 98% shut off button which is meant to reduce the water flow to a small stream. This feature does not shut the water off completely.

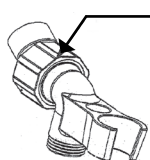
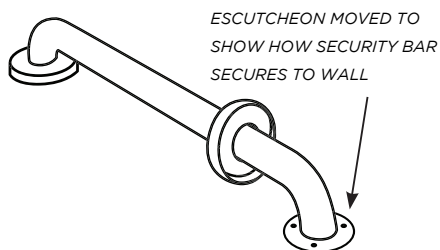

NOTE: If your personal sprayer doesn't stay in position or drops down, tighten the packing nut $\frac{1}{4}$ turn clockwise

FIGURE 1

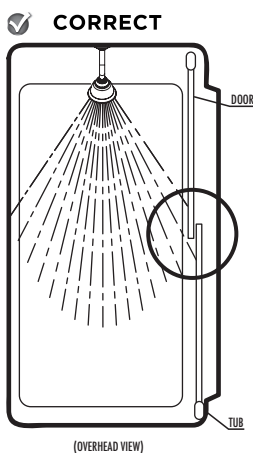
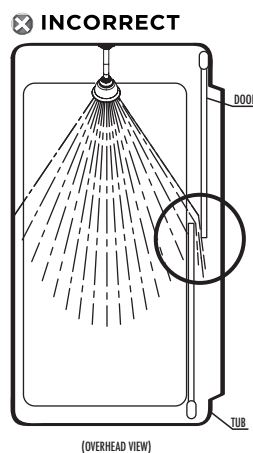

FIGURE 2



98% SHUT-OFF
DIVERTER

Troubleshooting Guide for Your Bath Fitter Unit

Save Time! Try these troubleshooting methods at home before calling to make an appointment for service.

SYMPTOM POSSIBLE SOLUTION

Slow tub drain

Remove any debris from the drain area, then follow these simple steps in this order:

1. Pour 1/4 cup baking soda into the drain.
2. Pour 1/4 cup white vinegar into the drain.
3. Wait just a few minutes, then flush the drain with 5-6 gallons of very hot water.
4. Plunge (you may need to seal the overflow plate with a plastic bag or rag to get better suction when plunging).

If drain is still slow, repeat all steps 4-5 times. If you still have a slow drain, the clog may be further down your line, and it may be necessary to call a plumber. (See page 8.)

Slow shower drain

Use a soft bottle brush through the shower drain cover to gently remove the debris. The shower drain cover should not be removed.

If necessary, a flexible plastic drain stick (e.g. Zip-It) can be inserted in the drain to help remove hair from the drain. If not clogged by hair, fill the bottom of the bathtub with approximately 1" of water and use a plunger.

Cannot remove pop-up stopper

Please see diagram on page 8.

Constant drip from tub spout or shower head when unit is off

Dripping may be caused by a clogged or dirty cartridge. To flush the cartridge, turn the handle that controls the water flow on and off 15 times. Wait 30 minutes to see if the dripping stops. Repeat this cycle 5-6 times if needed.

Personal sprayer won't stay in position and drops down.

There is a packing nut on the back of the sprayer mount. Turn the nut about 1/4 of a turn clockwise to tighten.

See diagram on page 11.

The unit has lost its shine

Give the entire unit a good cleaning with an approved cleaner (see page 4), rinse thoroughly, and then apply Gel Gloss to the unit. Follow the manufacturer's instructions for use.

The floor of the unit feels slippery

Remove any excess soap build up on the floor with an approved cleaner and a Dobie Pad. Rinse thoroughly.

SYMPTOM POSSIBLE SOLUTION (Cont.)

No water coming out and you have a personal sprayer

Turn on the water. Change the 98% shut-off valve to the off position on the handheld sprayer (there will still be a small trickle). Next, change the position of the diverter at the top of the stationary shower head.

Hard water spots on the fixtures

Try cleaning the fixtures with CLR (a calcium, lime, and rust cleaner). Or try using a mild car wax or Bar Keepers Friend Spray Foam to clean the fixtures.

Shower head is clogged

Put some CLR in a plastic bag and rubber band it around the shower head, allowing it to soak until the hardened calcium build up has broken down. OR scrub the shower head nozzle with CLR and a soft brush to remove the calcium build up.

Frozen pipes

If you have an access panel behind the unit, apply a heat source (such as a hair dryer) to your pipes in order to get them flowing again. If there is a trickle of water coming from the fixture already, turn the water on to see if it will thaw the pipes. If neither method works, contact a plumber for assistance.

Mildew or mold on the silicone

Use Clorox Clean-Up Cleaner with Bleach (follow instructions on the bottle) to treat any affected areas until the issue resolves itself. Rinse cleaner off thoroughly after use.

The silicone may also be cleaned regularly with a 50/50 mix of water and regular chlorine bleach which will help to kill any germs and/or bacteria lying on the surface.

An environmentally friendly solution of water and white vinegar will also do a great job of eliminating mildew on silicone and is cost effective.

Tub spout diverter does not fall when done showering

This is normal due to air that gets siphoned into the line when turning off the water. Simply turn the water off then lightly tap or push the diverter down.

No water coming from shower head

Check the setting on the shower head to ensure it is clicked into place on one of the three settings.

I have no hot water in the Bath Fitter unit

If you've had any plumbing work done or any work done to a hot water heater in the home, please verify your hot water heater was turned back on.

FOR QUESTIONS CALL OUR WARRANTY DEPARTMENT

1-888-448-7250

or email warranty@bathsaver.com

© 2019 Bath Saver, Inc. All rights reserved.

Rvsd Date: 10/24/19; BF-121